

STQ16PC

STQ 16" TRACKLIGHT

THEATRICAL PRO SERIES / 3000 LUMENS

WATTAGE / LUMENS DATA					
PART NUMBER	PREVIOUS PART NUMBER EXAMPLE	SOURCE LUMENS ¹	DELIVERED LUMENS ²	SYSTEM WATTS	LPW
STQ16PC10L	STQ16XT10L ST-16LEDXT10L	1000	923	9.1	101
STQ16PC13L	STQ16XT13L ST-16LEDXT13L	1300	1243	13.0	96
STQ16PC20L	STQ16XT20L ST-16LEDXT20L	2000	1913	21.7	88
STQ16PC30L	STQ16XT30L	3000	2869	32.6	88

APPLICATION

STQ 16" Photo Style Series tracklight for accent display lighting and decorative lighting application.

FEATURES

Photo Style LED track light evokes the look of traditional theatrical fixtures. Fixture rotates 359° and tilts/locks 45°. Passive cooled Zhaga compliant LED module for future maintenance or upgrade. Quick twist LED optics for field adjustment. Track series available with a variety of surface, pendant and cord/clamp mounting.

FINISH

Multi-stage polyester powder-coat process applied on our dedicated paint lines. A wide variety of standard and custom finishes are available. All exposed materials are chromate pretreated to resist corrosion.

CONSTRUCTION

Fixtures are fabricated in our factory from 5052-H32 aluminum.

ELECTRONICS

LED module features state of the art, high efficiency LEDs. 3-step MacAdam Ellipse binning with 80 and 90 CRI available.

CODE COMPLIANCE

BAA Compliant. ETL certified to meet US and Canadian standards. Suitable for dry or damp locations. Manufactured and tested to UL Standards No. 1598/8750.

PRODUCT SELECTOR GUIDE

SERIES	LUMENS ¹	CCT	BEAM	DRIVER / VOLTAGE	ADAPTOR/MOUNTING	FINISH	ACCESSORIES
STQ16PC	20L	35K	MD	E1	BET/CP6	MW	2XHL3A

EXAMPLE

SERIES	LUMENS ¹		CCT		BEAM		DRIVER / VOLTAGE ⁴		ADAPTOR / MOUNTING		FINISH ¹⁰		ACCESSORIES ¹²					
STQ16PC Integral Barn Doors	10L	1000 Lm	83 CRI		XN ³ ND MD WD	10° 26° 48° 60°	E1	120V ≤ 5% Triac Leading Edge Phase Dimming	ADAPTOR		MW ¹¹ MB ¹¹ PT ¹¹ CC	Matte White Matte Black Platinum Silver Custom Color	SO GL FG SK HL	Micro Prism Solite™ Lens Clear Glass Lens Frosted Glass Lens Skytex™ Lens Hex Louver				
	13L	1300 Lm	27K 30K 35K 40K	2700K 3000K 3500K 4000K			D0101	≤ 5%, 0-10V Dimming, 120V	TEK100	Global TEK 2 CIR/2 NEUT 120V					HTEK100	Global TEK 2 CIR/2 NEUT 277V		
	20L	2000 Lm					E2	Non-Dimming Electronic Driver, 277V	D0102	≤ 5%, 0-10V Dimming, 277V					BET	Basix 1 CIR/1 NEUT 120V	OT2D	120V 2 Circuit 6 Conductor, 0-10V Dimmable
	30L	3000 Lm													HOT2D	277V 2 Circuit 6 Conductor, 0-10V Dimmable		
															MOUNTING			
							PC1	Pipe Clamp										
							CP6	6" Straight Cord & Plug										
							CP24	24" Straight Cord & Plug										
							CCP6	6" Coil Cord & Plug										
							CP5	5" Round Surface Mount Canopy (120V/277V)										
						MPT3 ⁹	Monopoint Canopy											
						PM(xx) ⁹	Pendant with Track Adaptor, PC1 or CP5											
STX16PC No Barn Doors			98 CRI															
			27HK	2700K														
			30HK	3000K														
			35HK	3500K														
			40HK	4000K														

EXAMPLE: STQ16PC10L27KNDE1/TEK100/PM36/MW/SO

NOTES:

1 Nominal Source Lumens at Any CCT 2 Nominal Delivered Lumens at 83 CRI at Any CCT With ND, No Lens 3 9mm, 13L Max, All XN Draw More Watts Than Other Optics; See Photometry 4 Contact Factory for Additional Options 5 277V Requires HTEK 277V Track and Adaptor 6 Requires TP3 Adaptor and XTSC PULSE Track System, 120V Only 7 120V 0-10V Only 8 120V Only / GES66 Adaptor 9 Specify Length in Inches 10 Reference Color Sheet Located on Product Webpage for Full List of Available Colors 11 Standard Finishes 12 Accessory Finish Will Match Fixture

COPYRIGHT 2022 SPECTRUM LIGHTING, INC.

PROJECT:

QUANTITY:

TYPE:

SPEC
TRAC

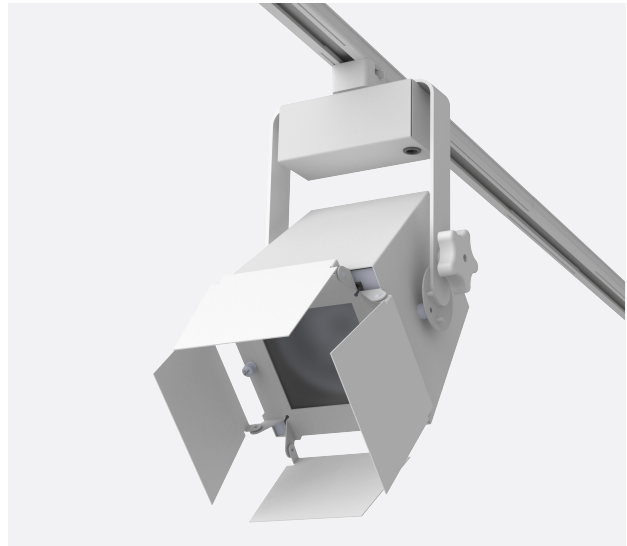

FIXTURE DIMENSIONS

STQ16PC - Integral Barn Doors

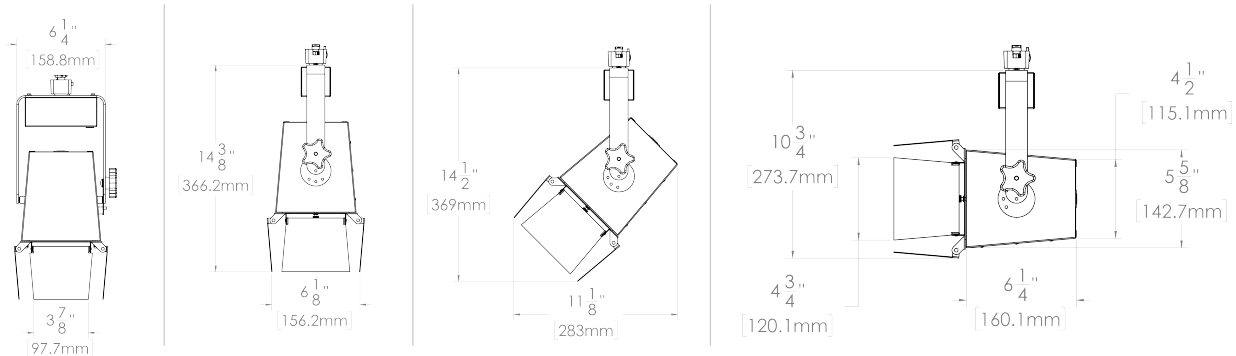

STX16PC - No Barn Doors

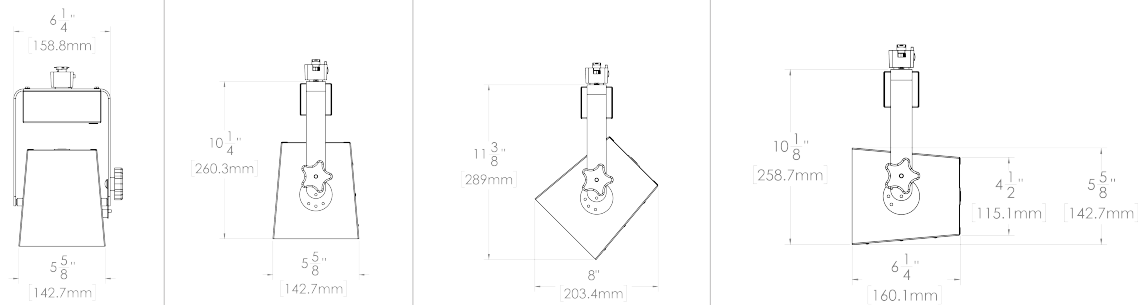

FINISH

Black adaptor standard for all finishes excluding MW which comes with white adaptor.

MW - MATTE WHITE

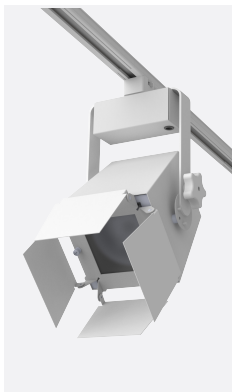

MB - MATTE BLACK



PT - PLATINUM



ADAPTOR

BET
 Basic 1 CIR/1 NEUT 120V

TEK100
 Global TEK 2 CIR/2 NEUT 120V

OT2D
 120V 2 Circuit 6 Conductor,
 0-10V Dimmable

HTEK100
 Global TEK 2 CIR/2 NEUT 277V

HOT2D
 277V 2 Circuit 6 Conductor,
 0-10V Dimmable
