



PROJECT: _____
 QUANTITY: _____ TYPE: _____

2'X 2' MODULAR ACCENT LIGHT

GRID CEILING

LED SERIES / MULTI-MODULE / 5000 LUMENS / 2 × 5000 & 4 × 5000 LUMENS / 4" DIAMETER MODULES

GC24241XPC / GC24242XPC / GC24244XPC FLUSH TRIM / NON-IC RATED

APPLICATION

GC 2' x 2' Series LED accent light designed for automotive and retail applications where crisp focused light is desired.

FEATURES

Unique fixture designed to convert standard 2' x 2' fixtures into high powered accent light. Fixture modules rotate 359°, lock and tilt for 30° for optimal aiming. Fits seamlessly into 2' x 2' grid ceiling. Front loading lamp bezel accepts up to two lens/louver options.

TRIM FINISH

A variety of architectural powdercoat finishes are available.

ELECTRONICS

LED system features state of the art, high efficiency LEDs providing consistent stable color with excellent CCT control over the life of the light engine. Base 80 min CRI with 3-step MacAdam ellipse binning. High CRI of 90 min is also available as a standard option. A variety of electronic 120/277V and dimming options are available.

CONSTRUCTION

Housing constructed of #18 ga. Galvanized steel to resist corrosion.

CODE COMPLIANCE

BAA Compliant. Non-IC rated. ETL certified to meet US and Canadian standards. Suitable for dry or damp locations. Manufactured and tested to UL standards No. 1598/8750.



SERIES	LUMENS ¹	CCT	BEAM ²	DRIVER / VOLTAGE	OPTIONS ³	INTERIOR	TRIM	FINISHES
GC24241XPC 1 Module	10L 700 Lm	80 CRI	ND 16°	D1 1% 0-10V, 120V	LENS NL No Lens SO35 Solite Diffusion GL35 Clear Glass Lens HL35 Hex Louver SN35 ⁴ Snoot	MWI Matte White Interior MBI Matte Black Interior PTI Platinum Silver Interior BZI Bronze Interior CCI Custom Color Interior	FWT24241RH 1 x LED	MW Matte White MB Matte Black PT Platinum Silver BZ Bronze CC Custom Color
	20L 1400 Lm	27K 2700K	MD 26°	D2 1% 0-10V, 277V				
GC24242XPC 2 Module	30L 2000 Lm	30K 3000K	WD 36°		OPTIONS EM Emergency Battery	Reference Color Sheet Located on Product Webpage For Full List of Available Colors.	FWT24242RH 2 x LED	
	40L 2750 Lm	35K 3500K	XW 56°					
GC24244XPC 4 Module	50L ¹ 3500 Lm	40K 4000K					FWT24244RH 4 x LED	
		90 CRI						Reference Color Sheet Located on Product Webpage For Full List of Available Colors.
	1. 50L requires marked spacing 3/16" CTC/0.5" TOP/18 CTS	27HK 2700K 30HK 3000K 35HK 3500K 40HK 4000K	2. Beam angles represent one module					
					3. See Product Page for Details - Only 2 options can be combined 4. Flat Black Finish			

EXAMPLE: GC24241XPC20L27KNDD1HL35MBIFWT24241RHMB



2'X 2' MODULAR ACCENT LIGHT



FIXTURE DIMENSIONS

GC24241XPC - 1 MODULE

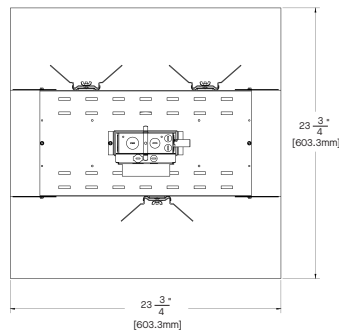
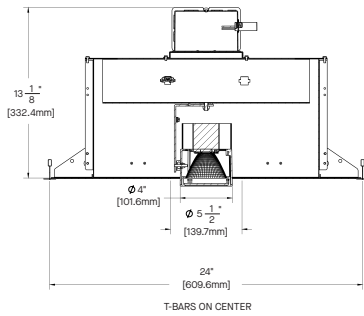

GC24242XPC - 2 MODULES

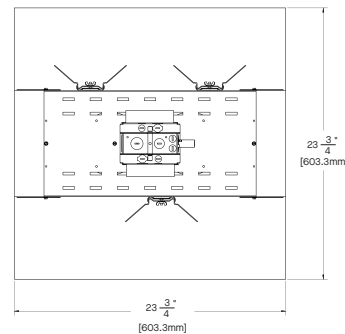
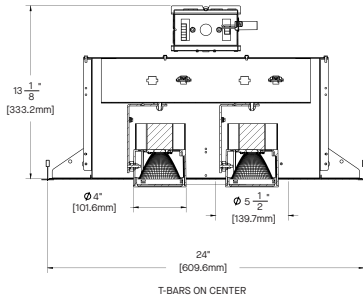

GC24244XPC - 4 MODULES

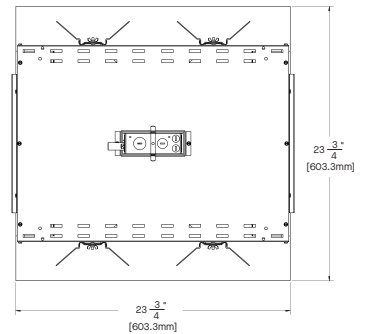
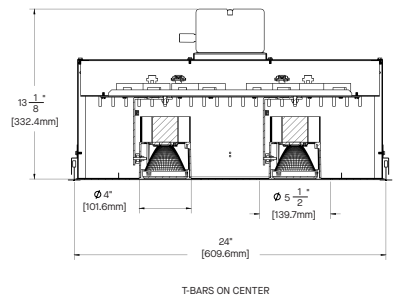

LUMENS / WATTAGE DATA

PART NUMBER	SOURCE LUMENS ¹	DELIVERED LUMENS ²	SYSTEM WATTS	LPW
GC24241XPC10L	1000	686	7.4	93
GC24241XPC20L	2000	1372	13.2	104
GC24241XPC30L	3000	2059	20.4	101
GC24241XPC40L	4000	2745	28.1	98
GC24241XPC50L	5000	3431	35	98

¹ Nominal Source Lumens at 35K ² Nominal Delivered Lumens at 82 CRI with PC50L 35K WD xx xx LN4AGL

2'X 2' MODULAR ACCENT LIGHT



Photometric data shown represents a single module. For multi-module fixtures, use one IES file per module to ensure accurate lighting calculations.

GC24241XPC 50L 35K ND xx xx NL

CANDLEPOWER CURVE TEST SP-01364	INTENSITY CANDELA 0° AZIMUTH	ZONAL LUMENS	SINGLE UNIT: PERFORMANCE HORIZONTAL FOOTCANDLES INITIAL DOWNLIGHT ONLY				MULTIPLE UNITS: PERFORMANCE 80/50/20% REFLECTANCES HORIZONTAL FOOTCANDLES AND WATTS/SQ FT							
			Mounting Distance	FC at Beam Center	Diameter at Beam Angle	FC at Beam Edge	Ceiling Height	Fixture Spacing	RCR 4		RCR 6			
	0°	0° - 10°	1260	35%	6.5'	439 fc	2.2'	210 fc	18'	4'	210	2.16	196	2.17
	0°	0° - 20°	2487	69%	7.5'	330 fc	2.6'	158 fc	22'	5'	129	1.33	120	1.34
	5°	0° - 30°	3208	90%	8.5'	257 fc	2.9'	123 fc	26'	6'	87	0.90	81	0.90
	15°	0° - 40°	3408	95%	10.0'	186 fc	3.4'	89 fc	Delivered Illuminance Rating: (DIR)		97 FC per W/Sq. Ft.		90 FC per W/Sq. Ft.	
	25°	0° - 60°	3478	97%	12.0'	129 fc	4.1'	62 fc	1' Suspension Length to luminous aperture Square rooms used for multiple units: RCR 4: Length & Width = Ceiling Ht. - 3.5' x 2.50 RCR 6: Length & Width = Ceiling Ht. - 3.5' x 1.66 * Average Initial Footcandles at 2.5' Above Floor					
	35°	0° - 80°	3559	99%	14.0'	95 fc	4.8'	45 fc						
	45°	0° - 90°	3571	100%	16.0'	73 fc	5.5'	35 fc						
	55°	0° - 90°	3571	100%	20.0'	46 fc	6.9'	22 fc						
	90°	Total	3580	100%										

Delivered Lumens: 3580
Luminaire Watts: 35
LER: 102.29

CP at 0° (Nadir): 18567
CRI: 80

Beam Angle: 20°
Spacing Ratio: 0.33

Lumen Multiplier: 10L x 0.20, 20L x 0.40, 30L x 0.60, 40L x 0.80
CCT Multiplier: 27K x 0.95, 30K x 0.98, 40K x 1.03

GC24241XPC 50L 35K MD xx xx NL

CANDLEPOWER CURVE TEST SP-01362	INTENSITY CANDELA 0° AZIMUTH	ZONAL LUMENS	SINGLE UNIT: PERFORMANCE HORIZONTAL FOOTCANDLES INITIAL DOWNLIGHT ONLY				MULTIPLE UNITS: PERFORMANCE 80/50/20% REFLECTANCES HORIZONTAL FOOTCANDLES AND WATTS/SQ FT							
			Mounting Distance	FC at Beam Center	Diameter at Beam Angle	FC at Beam Edge	Ceiling Height	Fixture Spacing	RCR 3		RCR 5			
	0°	0° - 10°	992	29%	6.5'	314 fc	2.8'	147 fc	18'	6"	94	0.96	93	1.04
	0°	0° - 20°	2321	67%	7.5'	236 fc	3.2'	110 fc	22'	7"	73	0.75	57	0.64
	5°	0° - 30°	3104	89%	8.5'	184 fc	3.6'	86 fc	26'	8"	49	0.51	56	0.62
	15°	0° - 40°	3306	95%	10.0'	133 fc	4.3'	62 fc	Delivered Illuminance Rating: (DIR)		98 FC per W/Sq. Ft.		89 FC per W/Sq. Ft.	
	25°	0° - 60°	3382	97%	12.0'	92 fc	5.1'	43 fc	1' Suspension Length to luminous aperture Square rooms used for multiple units: RCR 3: Length & Width = Ceiling Ht. - 3.5' x 3.33 RCR 5: Length & Width = Ceiling Ht. - 3.5' x 2.00 * Average Initial Footcandles at 2.5' Above Floor * Exceeds Spacing Ratio by 3%					
	35°	0° - 80°	3459	99%	14.0'	68 fc	6.0'	32 fc						
	45°	0° - 90°	3473	100%	16.0'	52 fc	6.8'	24 fc						
	55°	0° - 90°	3473	100%	20.0'	33 fc	8.5'	16 fc						
	90°	Total	3481	100%										

Delivered Lumens: 3481
Luminaire Watts: 35
LER: 99.46

CP at 0° (Nadir): 13276
CRI: 80

Beam Angle: 24°
Spacing Ratio: 0.40

Lumen Multiplier: 10L x 0.20, 20L x 0.40, 30L x 0.60, 40L x 0.80
CCT Multiplier: 27K x 0.95, 30K x 0.98, 40K x 1.03

HOW TO USE PERFORMANCE DATA

SINGLE UNIT	MULTIPLE UNITS
<p>Cone of Light of a single, symmetrical beam luminaire. Direct initial illumination (FC) and Beam Angle diameter directly beneath fixture; shown at different distances from aperture to horizontal plane. Calculated using Inverse Square Law.</p> $FC_H = CP \times (\cos \theta) \div D^2$ <p>Beam Diam. = ½ Beam Angle (Tan) x 2D</p> <ul style="list-style-type: none"> • CP Candela at 0° (Nadir) • Cos θ Cosine of θ Angle • D Distance (Mounting Height AFF) • FC_H Footcandles, Horizontal • Beam Angle Cone of light to 50% max. CP • Beam Diam. Pattern of light at Beam Angle 	<p>Square grid layout of multiple luminaires in unfurnished, square rooms of different proportions (Room Cavity Ratios) with 80/50/20% room surface reflectances. 2' Suspension Length to aperture. Initial average illumination (FC) calculated at 2.5' above floor, using Zonal Cavity Method. W/Sq. Ft. of layout shown for each ceiling height and RCR.</p> <p>Delivered Illuminance Rating (DIR*): System performance indicator expressed as ratio of approximate initial FC per W/Sq. Ft. delivered to horizontal plane below, for the range of ceiling heights indicated.</p> <ul style="list-style-type: none"> • To estimate FC for Fixture Spacing that is different than shown (do not exceed Spacing Ratio): $FC = \text{Chart Spacing}^2 \div \text{Different Spacing}^2 \times \text{Chart FC}$ • To estimate Sq. Ft. per fixture for a specific target FC: $\text{Sq. Ft.} / \text{Fixture} = \text{Chart FC} \times \text{Chart Spacing}^2 \div \text{Target FC}$ <ul style="list-style-type: none"> • To estimate Fixture Quantity in a room: $\text{Fixture Qty.} = \text{Sq. Ft. of Rm.} \div \text{Sq. Ft. per fixture}$ • To estimate Watts/Sq. Ft.: $\text{W/Sq. Ft.} = \text{Luminaire Watts} \times \text{Qty.} \div \text{Sq. Ft. of Rm.}$

2'X 2' MODULAR ACCENT LIGHT



GC24241XPC 50L 35K WD xx xx NL

CANDLEPOWER CURVE TEST SP-01366	INTENSITY CANDELA 0° AZIMUTH	ZONAL LUMENS	SINGLE UNIT: PERFORMANCE HORIZONTAL FOOTCANDLES INITIAL DOWNLIGHT ONLY				MULTIPLE UNITS: PERFORMANCE 80/50/20% REFLECTANCES HORIZONTAL FOOTCANDLES AND WATTS/SQ FT							
			Mounting Distance	FC at Beam Center	Diameter at Beam Angle	FC at Beam Edge	Ceiling Height	Fixture Spacing	RCR 2		RCR 4			
	0°	0° - 10°	557	15%	6.5'	140 fc	5.9'	53 fc	14'	6'	108	1.03	76	0.81
	0°	0° - 20°	1892	52%	7.5'	105 fc	6.9'	39 fc	18'	8'	57	0.54	40	0.43
	5°	0° - 30°	3128	86%	8.5'	82 fc	7.8'	31 fc	22'	10'	35	0.33	25	0.26
	15°	0° - 40°	3445	95%	10.0'	59 fc	9.2'	22 fc	Delivered Illuminance Rating: (DIR)		105 FC per W/Sq. Ft.		94 FC per W/Sq. Ft.	
	25°	0° - 60°	3526	97%	12.0'	41 fc	11.0'	15 fc	1' Suspension Length to luminous aperture Square rooms used for multiple units: RCR 2: Length & Width = Ceiling Ht. - 3.5' x 5.00 RCR 4: Length & Width = Ceiling Ht. - 3.5' x 2.50 * Average Initial Footcandles at 2.5' Above Floor					
	35°	0° - 80°	3597	99%	14.0'	30 fc	12.8'	11 fc						
	45°	0° - 90°	3610	100%	16.0'	23 fc	14.6'	9 fc						
	55°	0° - 90°	3610	100%	20.0'	15 fc	18.3'	6 fc						
	90°	90°	2											
		Total	3620	100%										

Delivered Lumens: 3620
Luminaire Watts: 35
LER: 103.43

CP at 0° (Nadir): 5899
CRI: 80

Beam Angle: 49°
Spacing Ratio: 0.78

Lumen Multiplier: 10L x 0.20, 20L x 0.40, 30L x 0.60, 40L x 0.80
CCT Multiplier: 27K x 0.95, 30K x 0.98, 40K x 1.03

GC24241XPC 50L 35K XW xx xx NL

CANDLEPOWER CURVE TEST SP-01368	INTENSITY CANDELA 0° AZIMUTH	ZONAL LUMENS	SINGLE UNIT: PERFORMANCE HORIZONTAL FOOTCANDLES INITIAL DOWNLIGHT ONLY				MULTIPLE UNITS: PERFORMANCE 80/50/20% REFLECTANCES HORIZONTAL FOOTCANDLES AND WATTS/SQ FT							
			Mounting Distance	FC at Beam Center	Diameter at Beam Angle	FC at Beam Edge	Ceiling Height	Fixture Spacing	RCR 2		RCR 4			
	0°	0° - 10°	410	11%	6.5'	103 fc	7.2'	34 fc	14'	8'	48	0.46	42	0.46
	0°	0° - 20°	1559	43%	7.5'	77 fc	8.3'	26 fc	18'	10'	34	0.33	22	0.24
	5°	0° - 30°	2964	82%	8.5'	60 fc	9.4'	20 fc	22'	12'	21	0.20	24	0.26
	15°	0° - 40°	3444	95%	10.0'	43 fc	11.1'	15 fc	Delivered Illuminance Rating: (DIR)		105 FC per W/Sq. Ft.		93 FC per W/Sq. Ft.	
	25°	0° - 60°	3541	98%	12.0'	30 fc	13.3'	10 fc	1' Suspension Length to luminous aperture Square rooms used for multiple units: RCR 2: Length & Width = Ceiling Ht. - 3.5' x 5.00 RCR 4: Length & Width = Ceiling Ht. - 3.5' x 2.50 * Average Initial Footcandles at 2.5' Above Floor					
	35°	0° - 80°	3608	99%	14.0'	22 fc	15.5'	7 fc						
	45°	0° - 90°	3621	100%	16.0'	17 fc	17.7'	6 fc						
	55°	0° - 90°	3621	100%	20.0'	11 fc	22.1'	4 fc						
	90°	90°	2											
		Total	3630	100%										

Delivered Lumens: 3630
Luminaire Watts: 35
LER: 103.71

CP at 0° (Nadir): 4345
CRI: 80

Beam Angle: 58°
Spacing Ratio: 0.96

Lumen Multiplier: 10L x 0.20, 20L x 0.40, 30L x 0.60, 40L x 0.80
CCT Multiplier: 27K x 0.95, 30K x 0.98, 40K x 1.03

HOW TO USE PERFORMANCE DATA

SINGLE UNIT	MULTIPLE UNITS
<p>Cone of Light of a single, symmetrical beam luminaire. Direct initial illumination (FC) and Beam Angle diameter directly beneath fixture; shown at different distances from aperture to horizontal plane. Calculated using Inverse Square Law.</p> $FC_H = CP \times (\cos \theta) \div D^2$ <p>Beam Diam. = ½ Beam Angle (Tan) x 2D</p> <ul style="list-style-type: none"> • CP Candela at 0° (Nadir) • Cos θ Cosine of θ Angle • D Distance (Mounting Height AFF) • FC_H Footcandles, Horizontal • Beam Angle Cone of light to 50% max. CP • Beam Diam. Pattern of light at Beam Angle 	<p>Square grid layout of multiple luminaires in unfurnished, square rooms of different proportions (Room Cavity Ratios) with 80/50/20% room surface reflectances. 2' Suspension Length to aperture. Initial average illumination (FC) calculated at 2.5' above floor, using Zonal Cavity Method. W/Sq. Ft. of layout shown for each ceiling height and RCR.</p> <p>Delivered Illuminance Rating (DIR*): System performance indicator expressed as ratio of approximate initial FC per W/Sq. Ft. delivered to horizontal plane below, for the range of ceiling heights indicated.</p> <ul style="list-style-type: none"> • To estimate FC for Fixture Spacing that is different than shown (do not exceed Spacing Ratio): $FC = \text{Chart Spacing}^2 \div \text{Different Spacing}^2 \times \text{Chart FC}$ • To estimate Sq. Ft. per fixture for a specific target FC: $\text{Sq. Ft.} / \text{Fixture} = \text{Chart FC} \times \text{Chart Spacing}^2 \div \text{Target FC}$ • To estimate Fixture Quantity in a room: $\text{Fixture Qty.} = \text{Sq. Ft. of Rm.} \div \text{Sq. Ft. per fixture}$ • To estimate Watts/Sq. Ft.: $\text{W/Sq. Ft.} = \text{Luminaire Watts} \times \text{Qty.} \div \text{Sq. Ft. of Rm.}$