

8" MODULAR ACCENT LIGHT

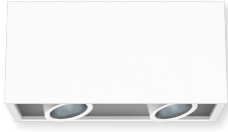

FIXTURE DIMENSIONS

SC816 - 1 OR 2 MODULES



SIDE VIEW WITH PULLOUT

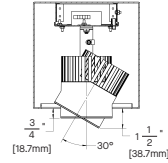

LUMENS / WATTAGE DATA				
PART NUMBER	SOURCE LUMENS ¹	DELIVERED LUMENS ²	SYSTEM WATTS	LPW
SC8_P1PC10L	1000	686	7.4	93
SC8_P1PC20L	2000	1372	13.2	104
SC8_P1PC30L	3000	2059	20.4	101
SC8_P1PC40L	4000	2745	28.1	98
SC8_P1PC50L	5000	3431	35	98

¹ Nominal Source Lumens at 35K ² Nominal Delivered Lumens at 62 CRI with PC50L 35K WD xx xx LMIAGL

PATTERN P1 - 1 LED MODULE

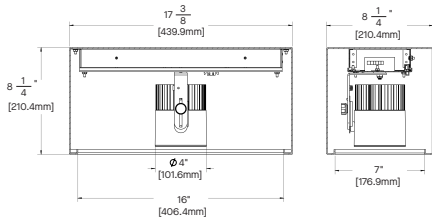

PATTERN P2 - 2 LED MODULES

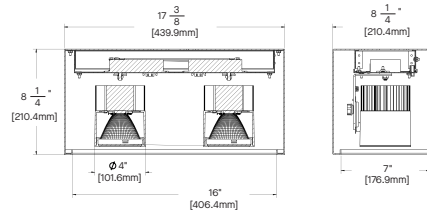

SC824 - 1 TO 3 MODULES

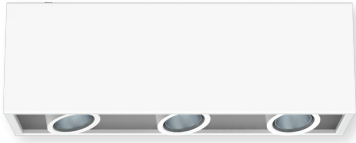

PATTERN P1 - 1 LED MODULE

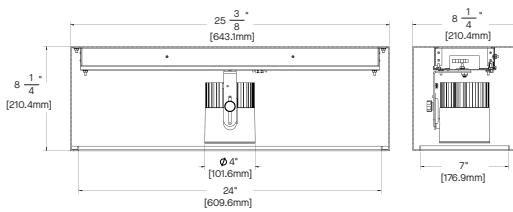

PATTERN P2 - 2 LED MODULE

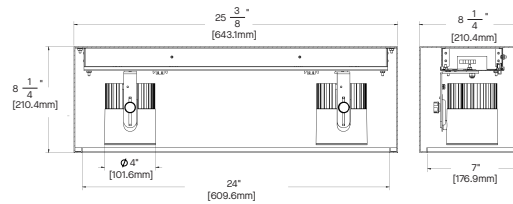

PATTERN P3 - 3 LED MODULE

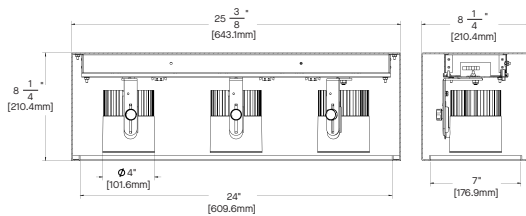

8" MODULAR ACCENT LIGHT



FIXTURE DIMENSIONS

SC848 - 2 TO 4 MODULES

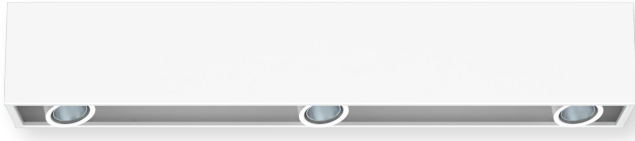

PATTERN P1 - 2 LED MODULE

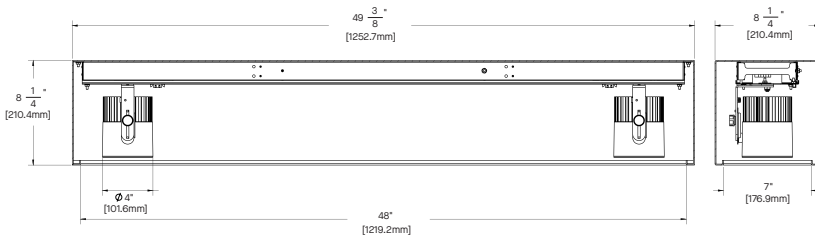

PATTERN P2 - 3 LED MODULE

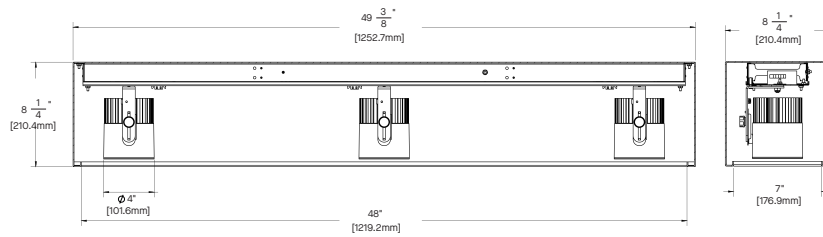

PATTERN P3 - 4 LED MODULE

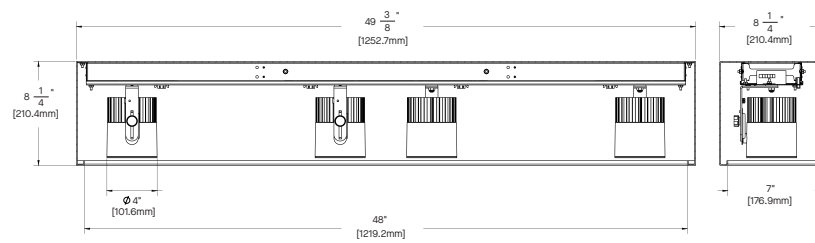

PATTERN P4 - 4 LED MODULE

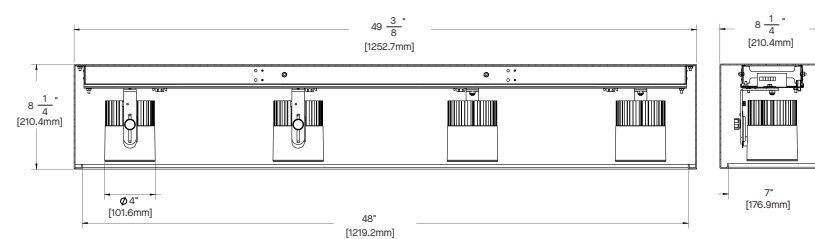

8" MODULAR ACCENT LIGHT



FIXTURE DIMENSIONS

SC896 - 4 TO 8 MODULES

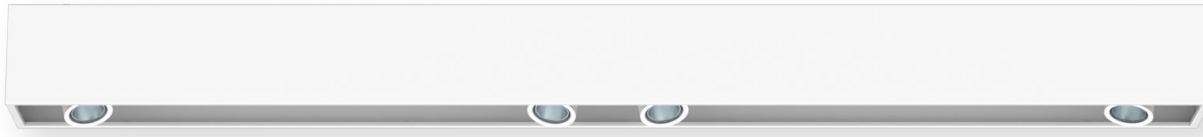

PATTERN P1 - 4 LED MODULE

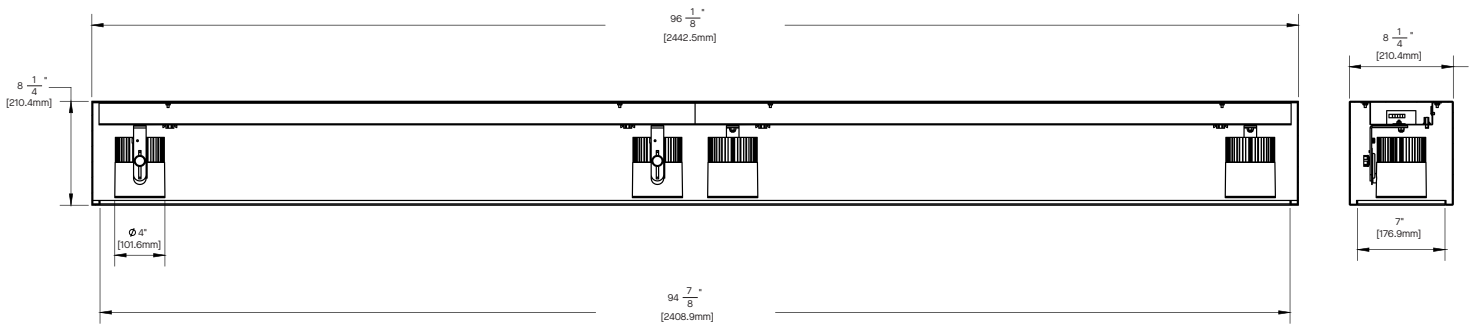

PATTERN P2 - 6 LED MODULE

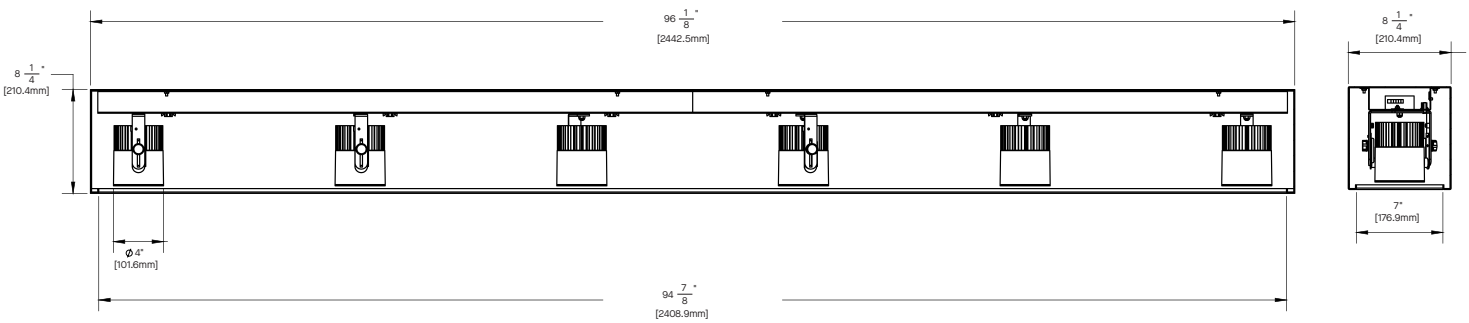

PATTERN P3 - 6 LED MODULE

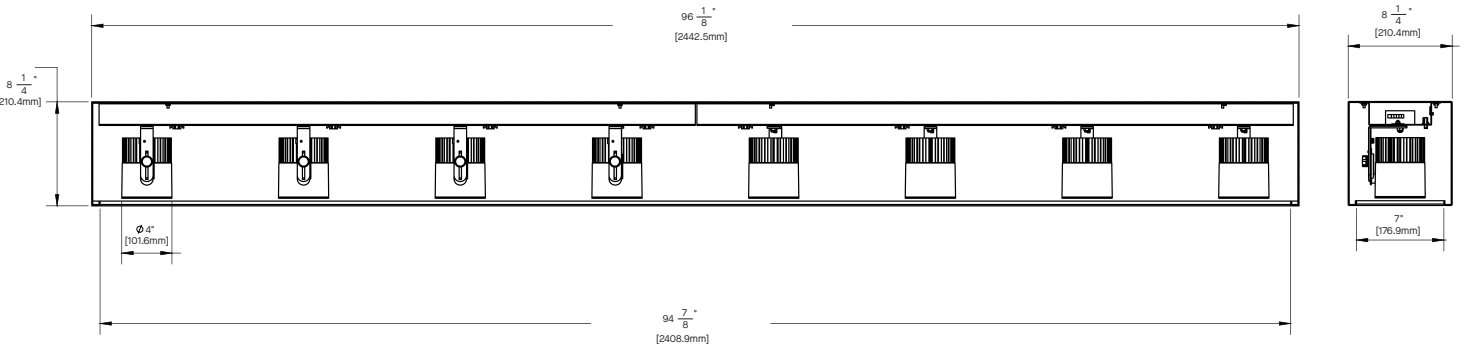

8" MODULAR ACCENT LIGHT



Photometric data shown represents a single module. For multi-module fixtures, use one IES file per module to ensure accurate lighting calculations.

SC8_P1PC 50L 35K ND xx xx NL

CANDLEPOWER CURVE TEST SP-01364	INTENSITY CANDELA 0° AZIMUTH	ZONAL LUMENS	SINGLE UNIT: PERFORMANCE HORIZONTAL FOOTCANDLES INITIAL DOWNLIGHT ONLY				MULTIPLE UNITS: PERFORMANCE 80/50/20% REFLECTANCES HORIZONTAL FOOTCANDLES AND WATTS/SQ FT										
			Mounting Distance	FC at Beam Center	Diameter at Beam Angle	FC at Beam Edge	Ceiling Height	Fixture Spacing	RCR 4		RCR 6						
	0°	0° - 10°	1260	35%													
	0°	0° - 20°	2487	69%	6.5'	439 fc	2.2'	210 fc	18'	4'	210	2.16	196	2.17			
	5°	0° - 30°	3208	90%	7.5'	330 fc	2.6'	158 fc	22'	5'	129	1.33	120	1.34			
	15°	0° - 40°	3408	95%	8.5'	257 fc	2.9'	123 fc	26'	6'	87	0.90	81	0.90			
	25°	0° - 60°	3478	97%	10.0'	186 fc	3.4'	89 fc	Delivered Illuminance Rating: (DIR)		97 FC per W/Sq. Ft.		90 FC per W/Sq. Ft.				
	35°	0° - 80°	3559	99%	12.0'	129 fc	4.1'	62 fc	1' Suspension Length to luminous aperture								
	45°	0° - 90°	3571	100%	14.0'	95 fc	4.8'	45 fc	Square rooms used for multiple units:								
	55°	Total	3580	100%	16.0'	73 fc	5.5'	35 fc	RCR 4: Length & Width = Ceiling Ht. - 3.5' x 2.50								
	90°				20.0'	46 fc	6.9'	22 fc	RCR 6: Length & Width = Ceiling Ht. - 3.5' x 1.66								
									* Average Initial Footcandles at 2.5' Above Floor								

Delivered Lumens: 3580
Luminaire Watts: 35
LER: 102.29

CP at 0° (Nadir): 18567
CRI: 80

Beam Angle: 20°
Spacing Ratio: 0.33

Lumen Multiplier: 10L x 0.20, 20L x 0.40, 30L x 0.60, 40L x 0.80
CCT Multiplier: 27K x 0.95, 30K x 0.98, 40K x 1.03

SC8_P1PC 50L 35K MD xx xx NL

CANDLEPOWER CURVE TEST SP-01362	INTENSITY CANDELA 0° AZIMUTH	ZONAL LUMENS	SINGLE UNIT: PERFORMANCE HORIZONTAL FOOTCANDLES INITIAL DOWNLIGHT ONLY				MULTIPLE UNITS: PERFORMANCE 80/50/20% REFLECTANCES HORIZONTAL FOOTCANDLES AND WATTS/SQ FT										
			Mounting Distance	FC at Beam Center	Diameter at Beam Angle	FC at Beam Edge	Ceiling Height	Fixture Spacing	RCR 3		RCR 5						
	0°	0° - 10°	992	29%													
	0°	0° - 20°	2321	67%	6.5'	314 fc	2.8'	147 fc	18'	6"	94	0.96	93	1.04			
	5°	0° - 30°	3104	89%	7.5'	236 fc	3.2'	110 fc	22'	7"	73	0.75	57	0.64			
	15°	0° - 40°	3306	95%	8.5'	184 fc	3.6'	86 fc	26'	8"	49	0.51	56	0.62			
	25°	0° - 60°	3382	97%	10.0'	133 fc	4.3'	62 fc	Delivered Illuminance Rating: (DIR)		98 FC per W/Sq. Ft.		89 FC per W/Sq. Ft.				
	35°	0° - 80°	3459	99%	12.0'	92 fc	5.1'	43 fc	1' Suspension Length to luminous aperture								
	45°	0° - 90°	3473	100%	14.0'	68 fc	6.0'	32 fc	Square rooms used for multiple units:								
	55°	Total	3481	100%	16.0'	52 fc	6.8'	24 fc	RCR 3: Length & Width = Ceiling Ht. - 3.5' x 3.33								
	90°				20.0'	33 fc	8.5'	16 fc	RCR 5: Length & Width = Ceiling Ht. - 3.5' x 2.00								
									* Average Initial Footcandles at 2.5' Above Floor								
									* Exceeds Spacing Ratio by 3%								

Delivered Lumens: 3481
Luminaire Watts: 35
LER: 99.46

CP at 0° (Nadir): 13276
CRI: 80

Beam Angle: 24°
Spacing Ratio: 0.40

Lumen Multiplier: 10L x 0.20, 20L x 0.40, 30L x 0.60, 40L x 0.80
CCT Multiplier: 27K x 0.95, 30K x 0.98, 40K x 1.03

HOW TO USE PERFORMANCE DATA

SINGLE UNIT	MULTIPLE UNITS
<p>Cone of Light of a single, symmetrical beam luminaire. Direct initial illumination (FC) and Beam Angle diameter directly beneath fixture; shown at different distances from aperture to horizontal plane. Calculated using Inverse Square Law.</p> $FC_H = CP \times (\cos \theta) \div D^2$ <p>Beam Diam. = ½ Beam Angle (Tan) x 2D</p> <ul style="list-style-type: none"> CP Candela at 0° (Nadir) cos θ Cosine of θ Angle D Distance (Mounting Height AFF) FC_H Footcandles, Horizontal Beam Angle Cone of light to 50% max. CP Beam Diam. Pattern of light at Beam Angle 	<p>Square grid layout of multiple luminaires in unfurnished, square rooms of different proportions (Room Cavity Ratios) with 80/50/20% room surface reflectances. 2' Suspension Length to aperture. Initial average illumination (FC) calculated at 2.5' above floor, using Zonal Cavity Method. W/Sq. Ft. of layout shown for each ceiling height and RCR.</p> <p>Delivered Illuminance Rating (DIR*): System performance indicator expressed as ratio of approximate initial FC per W/Sq. Ft. delivered to horizontal plane below, for the range of ceiling heights indicated.</p> <ul style="list-style-type: none"> To estimate FC for Fixture Spacing that is different than shown (do not exceed Spacing Ratio): $FC = \text{Chart Spacing}^2 \div \text{Different Spacing}^2 \times \text{Chart FC}$ To estimate Sq. Ft. per fixture for a specific target FC: $\text{Sq. Ft.} / \text{Fixture} = \text{Chart FC} \times \text{Chart Spacing}^2 \div \text{Target FC}$ To estimate Fixture Quantity in a room: $\text{Fixture Qty.} = \text{Sq. Ft. of Rm.} \div \text{Sq. Ft. per fixture}$ To estimate Watts/Sq. Ft.: $\text{W/Sq. Ft.} = \text{Luminaire Watts} \times \text{Qty.} \div \text{Sq. Ft. of Rm.}$

8" MODULAR ACCENT LIGHT



SC8_P1PC 50L 35K WD xx xx NL

CANDLEPOWER CURVE TEST SP-01366	INTENSITY CANDELA 0° AZIMUTH	ZONAL LUMENS	SINGLE UNIT: PERFORMANCE HORIZONTAL FOOTCANDLES INITIAL DOWNLIGHT ONLY				MULTIPLE UNITS: PERFORMANCE 80/50/20% REFLECTANCES HORIZONTAL FOOTCANDLES AND WATTS/SQ FT							
			Mounting Distance	FC at Beam Center	Diameter at Beam Angle	FC at Beam Edge	Ceiling Height	Fixture Spacing	RCR 2		RCR 4			
	0°	0° - 10°	557	15%	6.5'	140 fc	5.9'	53 fc	14'	6'	108	1.03	76	0.81
	0°	0° - 20°	1892	52%	7.5'	105 fc	6.9'	39 fc	18'	8'	57	0.54	40	0.43
	5°	0° - 30°	3128	86%	8.5'	82 fc	7.8'	31 fc	22'	10'	35	0.33	25	0.26
	15°	0° - 40°	3445	95%	10.0'	59 fc	9.2'	22 fc	Delivered Illuminance Rating: (DIR)		105 FC per W/Sq. Ft.		94 FC per W/Sq. Ft.	
	25°	0° - 60°	3526	97%	12.0'	41 fc	11.0'	15 fc	1' Suspension Length to luminous aperture Square rooms used for multiple units: RCR 2: Length & Width = Ceiling Ht. - 3.5' x 5.00 RCR 4: Length & Width = Ceiling Ht. - 3.5' x 2.50 * Average Initial Footcandles at 2.5' Above Floor					
	35°	0° - 80°	3597	99%	14.0'	30 fc	12.8'	11 fc						
	45°	0° - 90°	3610	100%	16.0'	23 fc	14.6'	9 fc						
	55°	0° - 90°	3610	100%	20.0'	15 fc	18.3'	6 fc						
	90°	0° - 90°	3620	100%										
		Total	3620	100%										

Delivered Lumens: 3620
Luminaire Watts: 35
LER: 103.43

CP at 0° (Nadir): 5899
CRI: 80

Beam Angle: 49°
Spacing Ratio: 0.78

Lumen Multiplier: 10L x 0.20, 20L x 0.40, 30L x 0.60, 40L x 0.80
CCT Multiplier: 27K x 0.95, 30K x 0.98, 40K x 1.03

SC8_P1PC 50L 35K XW xx xx NL

CANDLEPOWER CURVE TEST SP-01368	INTENSITY CANDELA 0° AZIMUTH	ZONAL LUMENS	SINGLE UNIT: PERFORMANCE HORIZONTAL FOOTCANDLES INITIAL DOWNLIGHT ONLY				MULTIPLE UNITS: PERFORMANCE 80/50/20% REFLECTANCES HORIZONTAL FOOTCANDLES AND WATTS/SQ FT							
			Mounting Distance	FC at Beam Center	Diameter at Beam Angle	FC at Beam Edge	Ceiling Height	Fixture Spacing	RCR 2		RCR 4			
	0°	0° - 10°	410	11%	6.5'	103 fc	7.2'	34 fc	14'	8'	48	0.46	42	0.46
	0°	0° - 20°	1559	43%	7.5'	77 fc	8.3'	26 fc	18'	10'	34	0.33	22	0.24
	5°	0° - 30°	2964	82%	8.5'	60 fc	9.4'	20 fc	22'	12'	21	0.20	24	0.26
	15°	0° - 40°	3444	95%	10.0'	43 fc	11.1'	15 fc	Delivered Illuminance Rating: (DIR)		105 FC per W/Sq. Ft.		93 FC per W/Sq. Ft.	
	25°	0° - 60°	3541	98%	12.0'	30 fc	13.3'	10 fc	1' Suspension Length to luminous aperture Square rooms used for multiple units: RCR 2: Length & Width = Ceiling Ht. - 3.5' x 5.00 RCR 4: Length & Width = Ceiling Ht. - 3.5' x 2.50 * Average Initial Footcandles at 2.5' Above Floor					
	35°	0° - 80°	3608	99%	14.0'	22 fc	15.5'	7 fc						
	45°	0° - 90°	3621	100%	16.0'	17 fc	17.7'	6 fc						
	55°	0° - 90°	3621	100%	20.0'	11 fc	22.1'	4 fc						
	90°	0° - 90°	3630	100%										
		Total	3630	100%										

Delivered Lumens: 3630
Luminaire Watts: 35
LER: 103.71

CP at 0° (Nadir): 4345
CRI: 80

Beam Angle: 58°
Spacing Ratio: 0.96

Lumen Multiplier: 10L x 0.20, 20L x 0.40, 30L x 0.60, 40L x 0.80
CCT Multiplier: 27K x 0.95, 30K x 0.98, 40K x 1.03

HOW TO USE PERFORMANCE DATA

SINGLE UNIT	MULTIPLE UNITS
<p>Cone of Light of a single, symmetrical beam luminaire. Direct initial illumination (FC) and Beam Angle diameter directly beneath fixture; shown at different distances from aperture to horizontal plane. Calculated using Inverse Square Law.</p> $FC_H = CP \times (\cos \theta) \div D^2$ <p>Beam Diam. = ½ Beam Angle (Tan) x 2D</p> <ul style="list-style-type: none"> • CP Candela at 0° (Nadir) • Cos θ Cosine of θ Angle • D Distance (Mounting Height AFF) • FC_H Footcandles, Horizontal • Beam Angle Cone of light to 50% max. CP • Beam Diam. Pattern of light at Beam Angle 	<p>Square grid layout of multiple luminaires in unfurnished, square rooms of different proportions (Room Cavity Ratios) with 80/50/20% room surface reflectances. 2' Suspension Length to aperture. Initial average illumination (FC) calculated at 2.5' above floor, using Zonal Cavity Method. W/Sq. Ft. of layout shown for each ceiling height and RCR.</p> <p>Delivered Illuminance Rating (DIR*): System performance indicator expressed as ratio of approximate initial FC per W/Sq. Ft. delivered to horizontal plane below, for the range of ceiling heights indicated.</p> <p>- To estimate FC for Fixture Spacing that is different than shown (do not exceed Spacing Ratio): $FC = \text{Chart Spacing}^2 \div \text{Different Spacing}^2 \times \text{Chart FC}$</p> <p>- To estimate Sq. Ft. per fixture for a specific target FC: $\text{Sq. Ft.} / \text{Fixture} = \text{Chart FC} \times \text{Chart Spacing}^2 \div \text{Target FC}$</p> <p>- To estimate Fixture Quantity in a room: $\text{Fixture Qty.} = \text{Sq. Ft. of Rm.} \div \text{Sq. Ft. per fixture}$</p> <p>- To estimate Watts/Sq. Ft.: $\text{W/Sq. Ft.} = \text{Luminaire Watts} \times \text{Qty.} \div \text{Sq. Ft. of Rm.}$</p>