



8" ROUND DIRECT FOCUSED ILLUMINATION



CO812XT, CO816XT, CO824XT - WALL MOUNT

APPLICATION

8" round x 12", 16" or 24" high 8" diameter cylinder luminaire for accent and general illumination.

FEATURES

Spectrum's Cylinder series provides traditional architectural style with high performance and energy efficient illumination. Rugged design with flexible mounting, finish and LED options make these extremely versatile fixtures. Quick change LED module with interchangeable optics for fixture upgrade.

FINISH

Multi-stage polyester powder-coat process applied on our dedicated paint lines. See mounting and color pages for standard finishes. All exposed materials are chromate pre-treated to resist corrosion.

ELECTRONICS

LED system features Xicato LED module with proprietary phosphor technology that provides consistent stable color with CCT control of +/- 100K over life of the light engine. Base CRI is 83 with 2-step MacAdam Ellipse binning. High CRI is 98 with 1 x 2-step MacAdam Ellipse binning. Variety of electronic 120V/277V and dimming drivers.

CONSTRUCTION

Fabricated seamless aluminum fixture housing. Silicone gasket seals optical chamber. Specular primary optical reflectors provide high efficiency illumination. Impact resistant tempered glass lenses. Stainless steel hardware with galvanized steel brackets to resist corrosion. Trim formed from .063 thick high purity aluminum and finished to specification.

CODE COMPLIANCE

BAA compliant. ETL certified to meet US and Canadian standards. Suitable for dry or damp locations. Wet Location Option. Manufactured and tested to UL standards No. 1598/8750.

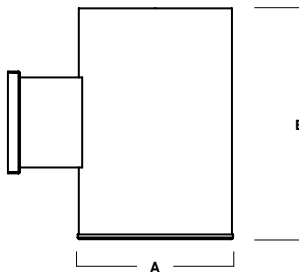

SERIES	A	B
CO812XT	8.0	12.1
CO816XT	8.0	16.1
CO824XT	8.0	24.1

Fixture Weight: 23.5 lbs

LUMENS / WATTAGE DATA				
PART NUMBER	SOURCE LUMENS	DELIVERED LUMENS ²	SYSTEM WATTS ³	LPW
CO812XT10L	1000	760	9.1	84
CO812XT13L	1300	1024	13.0	79
CO812XT20L	2000	1575	21.7	73

SERIES	LUMENS ¹	CCT	OPTICS	DRIVER / DIMMING ⁶	OPTIONS ⁷	TRIM	MOUNTING ⁹	FINISH ¹⁰
CO812XT ⁴ 8" x 12" Cylinder	10L 1000 Lm	83 CRI	XN 12°	EX Electronic Driver, 120V/277V	WL Wet Location	TSG Semi-Diffuse Low Iridescent Clear	WM3 Wall Mount 3" Extension WM5 Wall Mount 5" Extension	MW ¹¹ Matte White MB ¹¹ Matte Black PT ¹¹ Platinum Silver CC Custom Color
	13L 1300 Lm	27K 2700K	ND 22°					
	20L 2000 Lm	30K 3000K	MD 39°					
CO816XT ⁵ 8" x 16" Cylinder			35K 3500K	DS10X 10%, 0-10V, 120V/277V	FS Fuse Holder and Fuse Corrosion Resistant	TCY Same Color as Cylinder TCC Custom Color		
			40K 4000K	DO10X 1%, 0-10V, 120V/277V				
				DS2W1 ELV/MLV, 120V				
CO824XT ⁵ 8" x 24" Cylinder		98 CRI	27HK 2700K		CR Corrosion Resistant	NL ⁸ No Lens GL Clear Glass Lens FG Frosted Glass Lens SO Micro Prism Solite™ Lens	EMRM 7W Remote EM EMEN 7W Remote with Enclosure	
			30HK 3000K					
			35HK 3500K					
			40HK 4000K					

EXAMPLE: CO812XT20L35KNDEX/TSGGL/WM3/MW

NOTES:
 1 Nominal Source Lumens at Any CCT 2 Nominal Delivered Lumens at 83 CRI at Any CCT with MD-TSG-SO 3 At 83 CRI 4 98 CRI 13L Max, XN 80 CRI 13L Max, XN 98 CRI 10L Max 5 XN 80 CRI 13L Max, XN 98 CRI 10L Max
 6 Contact Factory for Additional Options 7 See Product Options Page for Details 8 Not Available with WL 9 See Mounting Page for Details on Components and Finishes 10 Reference Color Sheet Located on Product Webpage for Full List of Available Colors 11 Standard Finishes



PROJECT: _____
 TYPE: _____



Dimensions and values shown are nominal. Spectrum Lighting continually works to improve products and reserves the right to make changes which may alter the performance or appearance of products.

8" ROUND DIRECT

FOCUSED ILLUMINATION / FIXTURE OPTIONS



SERIES SIZES

C0812XT

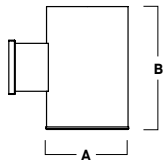

A	B
8.0	12.1
203.2 mm	307.3 mm

C0816XT

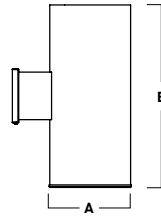

A	B
8.0	16.1
203.2 mm	408.9 mm

C0824XT

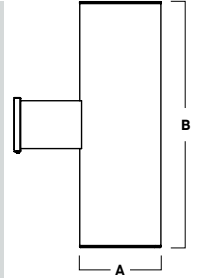
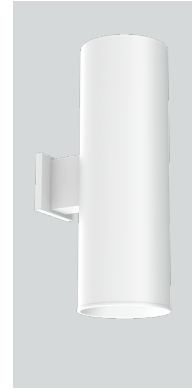

A	B
8.0	24.1
203.2 mm	612.1 mm

STANDARD FINISHES

MW
MATTE WHITE



MB
MATTE BLACK



PT
PLATINUM SILVER



WALL MOUNT DETAIL

WM3
WALL MOUNT 3" EXTENSION



FRONT VIEW

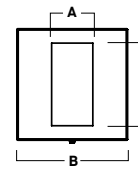

SIDE VIEW

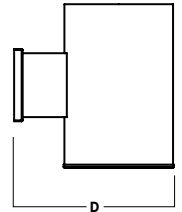

A	B	C	D
2.4	6.4	4.7	11.7
61.0 mm	162.6 mm	119.4 mm	297.2 mm

WM5
WALL MOUNT 5" EXTENSION



FRONT VIEW

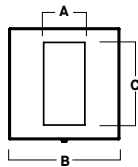

SIDE VIEW

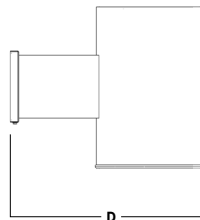

A	B	C	D
2.4	6.4	4.7	14.5
61.0 mm	162.6 mm	119.4 mm	368.3 mm

EMERGENCY BATTERY OPTIONS

EMRM* - 7W REMOTE EMERGENCY BATTERY
(50' MAX)

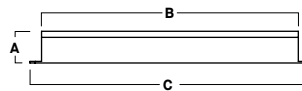

A	B	C
1.3	12.6	13.0

EMEN* - 7W REMOTE EMERGENCY BATTERY
WITH ENCLOSURE (50' MAX)

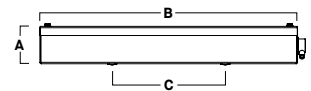

A	B	C
2.0	17.0	6.2

*OTHER EM BATTERY SIZES AVAILABLE, CONSULT FACTORY

8" ROUND DIRECT

FOCUSED ILLUMINATION / PHOTOMETRIC DATA



C08xxXT-30LxxK-NDEX-SGNL

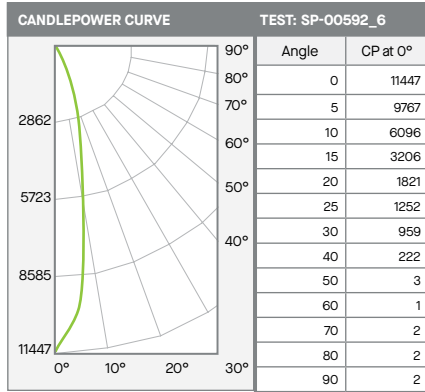

ZONAL LUMENS		
0-10	844	29%
0-20	1870	64%
0-30	2491	85%
0-40	2880	98%
0-60	2935	100%
0-80	2938	100%
0-90	2939	100%
Total Lumens	2939	100%

30L NARROW - 83 CRI

SINGLE UNIT: PERFORMANCE			
INITIAL FOOTCANDLES AND BEAM ANGLE DIAMETERS			
Mounting Height*	FC at Center	Diameter of Beam**	FC at Beam**
5.5'	378	2.1'	183
6.5'	271	2.5'	131
7.5'	204	2.8'	98
8.5'	158	3.2'	76
10.0'	114	3.8'	55
12.0'	79	4.5'	38
14.0'	58	5.3'	28
16.0'	45	6.0'	22

* From aperture to horizontal surface below.
** At IESNA defined Beam Angle, to 50% Max. CP.

Delivered Lumens: 2939 CP @ 0° (Nadir): 11447 Spacing Ratio: 0.36
 Luminaire Watts: 32.6 Beam Angle: 21.4° Output Multipliers: 10L x 0.32, 13L x 0.43, 20L x 0.67, 30L x 1.0
 LER: 90 CRI: 83

C08xxXT-30LxxK-MDEX-SGNL

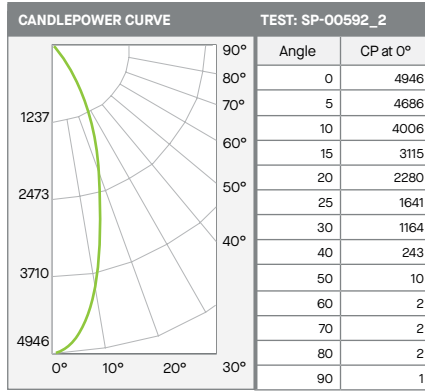

ZONAL LUMENS		
0-10	427	17%
0-20	1299	50%
0-30	2072	80%
0-40	2504	97%
0-60	2576	100%
0-80	2579	100%
0-90	2581	100%
Total Lumens	2581	100%

30L MEDIUM - 83 CRI

SINGLE UNIT: PERFORMANCE			
INITIAL FOOTCANDLES AND BEAM ANGLE DIAMETERS			
Mounting Height*	FC at Center	Diameter of Beam**	FC at Beam**
5.5'	164	3.8'	73
6.5'	117	4.4'	52
7.5'	88	5.1'	39
8.5'	68	5.8'	31
10.0'	49	6.8'	22
12.0'	34	8.2'	15
14.0'	25	9.6'	11
16.0'	19	10.9'	9

* From aperture to horizontal surface below.
** At IESNA defined Beam Angle, to 50% Max. CP.

Delivered Lumens: 2581 CP @ 0° (Nadir): 4946 Spacing Ratio: 0.62
 Luminaire Watts: 32.6 Beam Angle: 37.7° Output Multipliers: 10L x 0.32, 13L x 0.43, 20L x 0.67, 30L x 1.0
 LER: 79 CRI: 83

C08xxXT-30LxxK-WDEX-SGNL

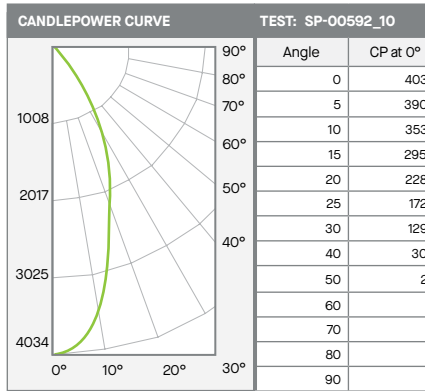

ZONAL LUMENS		
0-10	361	14%
0-20	1179	46%
0-30	1980	77%
0-40	2474	96%
0-60	2572	100%
0-80	2575	100%
0-90	2577	100%
Total Lumens	2577	100%

30L WIDE - 83 CRI

SINGLE UNIT: PERFORMANCE			
INITIAL FOOTCANDLES AND BEAM ANGLE DIAMETERS			
Mounting Height*	FC at Center	Diameter of Beam**	FC at Beam**
5.5'	133	4.5'	57
6.5'	95	5.4'	41
7.5'	72	6.2'	31
8.5'	56	7.0'	24
10.0'	40	8.2'	17
12.0'	28	9.9'	12
14.0'	21	11.5'	9
16.0'	16	13.2'	7

* From aperture to horizontal surface below.
** At IESNA defined Beam Angle, to 50% Max. CP.

Delivered Lumens: 2577 CP @ 0° (Nadir): 4034 Spacing Ratio: 0.7
 Luminaire Watts: 32.6 Beam Angle: 44.8° Output Multipliers: 10L x 0.32, 13L x 0.43, 20L x 0.67, 30L x 1.0
 LER: 79 CRI: 83

8" ROUND DIRECT

FOCUSED ILLUMINATION / PHOTOMETRIC DATA



CO8xxXT-30LxxK-XWEX-SGNL

30L XTRA WIDE - 83 CRI

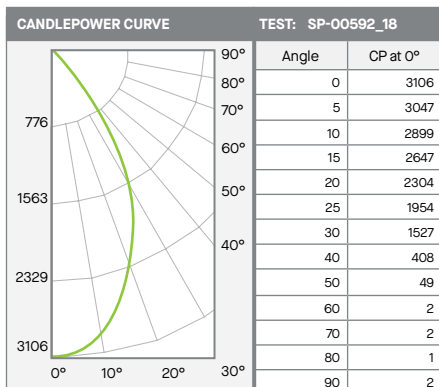

Zone	Lumens	%
0-10	286	11%
0-20	1021	38%
0-30	1915	71%
0-40	2525	94%
0-60	2679	100%
0-80	2683	100%
0-90	2685	100%
Total Lumens	2685	100%

Mounting Height*	FC at Center	Diameter of Beam**	FC at Beam**
5.5'	103	6.2'	39
6.5'	74	7.4'	28
7.5'	55	8.5'	21
8.5'	43	9.6'	16
10.0'	31	11.3'	12
12.0'	22	13.6'	8
14.0'	16	15.9'	6
16.0'	12	18.1'	5

* From aperture to horizontal surface below.
** At IESNA defined Beam Angle, to 50% Max. CP.

Delivered Lumens: 2685
Luminaire Watts: 32.6
LER: 82

CP @ 0° (Nadir): 3106
Beam Angle: 59.1°
CRI: 83

Spacing Ratio: 0.9
Output Multipliers: 10L x 0.32, 13L x 0.43, 20L x 0.67, 30L x 1.0