

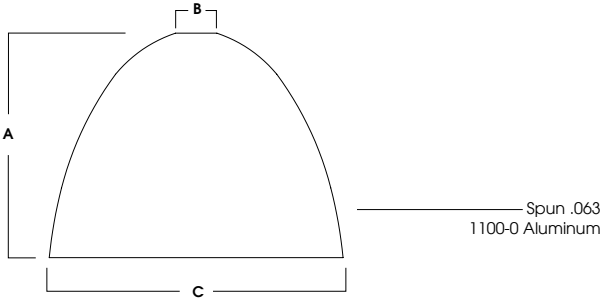

DOMO PENDANT
100 WATT MAX INC



SERIES	A	B	C
EG1612INC	12.6 320.0 mm	2.3 58.4 mm	16.2 411.5 mm

PROJECT: _____
QUANTITY: _____ TYPE: _____

EG1612INC

APPLICATION

Domo Pendant is perfect for decorative and retail lighting.

FEATURES

Spectrum Lighting's RLM Series are interpretations of classic lighting fixtures reimagined with modern INC light sources and materials. The wide range of combinations for illumination, mounting, enclosures, guards and finishes allows for creative fixture specification and design. A variety of lamp enclosures are available as well as guards and light shields. Fixtures may be wall or pendant mounted with standard or custom wall arm (goosenecks) and pendants. MR16 and LED lamping available.

FINISH

Multi-stage polyester powder-coat process applied on our dedicated paint lines. A wide variety of standard and custom finishes are available. All exposed materials are chromate pretreated to resist corrosion.

CONSTRUCTION

Fixture shades are spun in our factory from 0.063 high purity aluminum. Wall enclosures and fittings are die-cast aluminum with stainless steel hardware. Wall arms are formed 3/4 NPT aluminum pipe. Gaskets are machine cut neoprene.

CODE COMPLIANCE

ETL listed for damp locations. Manufactured and tested to UL standard No. 1598.

SERIES	LAMP	VOLTAGE	MOUNTING	FINISH ²
EG1612INC	100W	120V	PA See RLM Mounting Page for Available Arm Options CP5 Flat Ceiling Canopy CD Cable and Cord Mounting CM Cord Mount HM Hang Straight Pendant PM Pendant/Straight Mount CP6 Wall Interface	MB Matte Black GW Gloss White GB Gloss Black EG Evergreen VE Verde Green AY Aero Yellow BL Blue Streak OR Orange RD Red Baron BZ Bronze CO Copper Metallic SI Silver MM Metal Finish (Brushed Copper, Brushed Aluminum, Polished Brass) CC Custom Color

EXAMPLE: EG1612INC100WE1/HM24/GW

NOTES:
1 Specify Length in Inches: See Mounting Page for Available Lengths 2 Contact Factory for Special Finishes 3 Consult Factory



COLOR OPTIONS - POWDER COAT PAINT FINISHES

NOTE: NO PRINTED IMAGE CAN EQUAL THE EXACT COLOR OF FINISH ON METAL.
SEE INDIVIDUAL SPECIFICATION SHEETS OR CONSULT FACTORY FOR ADDITIONAL INFORMATION.



STANDARD CORD / STEM / CANOPY FINISHES

FIXTURE COLOR	STANDARD CORD COLOR	STANDARD CANOPY / STEM COLOR
Matte White, Textured White	Matte White	Matte White
Gloss White	Matte White	Gloss White
Matte Black, Gloss Black, Textured Black	Matte Black	Matte Black
All Others	Matte Black	Same Color as Fixture
Custom Color	Contact Factory	Contact Factory

PAINT TIMES

TIER	COST	AVERAGE PAINT TIME*
Tier 1 - Standard Finishes	\$	⓪
Tier 2 - Typical Finishes	\$\$	⓪⓪
Tier 3 - Special Metal Finishes	\$\$\$	⓪⓪⓪
Custom Color	Contact Factory	Contact Factory

*CONTACT FACTORY FOR SPECIFIC PRODUCT LEAD TIMES

TIER 1 - STANDARD FINISHES



TIER 2 - TYPICAL FINISHES



TIER 3 - SPECIAL METAL FINISHES



CUSTOM COLOR FINISHES

CONTACT FACTORY

CC
Custom Color



*UNAVAILABLE FOR WET LOCATION

**UNAVAILABLE FOR INTERIOR

