

INFINIUM™ PULSE TECH
RAZOR EDGE COVE LIGHT
 14 WATT MAXIMUM

SRT22
SPECTRUM
INFINIUM™

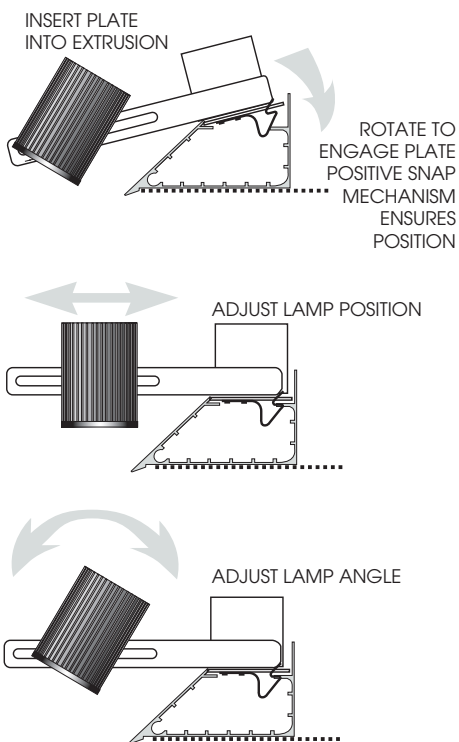

PRODUCT INFORMATION:

- Razor Edge Cove Fixture produces a seamlessly clean installation.
- Frame extrusion is mounted directly to building drywall and plastered in.
- Fixtures mount with a unique clip system that adjusts laterally. Fixtures tilt and lock.
- Infinium™ Pulse Tech features integral air-cooling technology.
- Single high powered LED produces point source quality and luminaire focus.
- 50,000 hours rated lamp life means low maintenance.
- High flux density 14w LED.
- All LED modules are replaceable and upgradable.
- Equivalent to 50w MR16, 20w Metal Halide, and 75w Incandescent lamps.
- Manufactured and tested to UL Standard No. 8750.

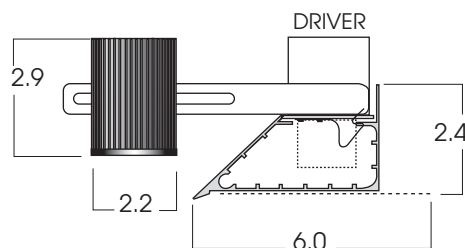

KELVIN°	WATTAGE	LUMENS
27K°	14W	350
31K°	14W	375
35K°	14W	400
41K°	14W	480
55K°	14W	560

RAZOR EDGE FIXTURE ORDERING

MODEL	LED	KELVIN	BEAM	DRIVER	FINISH
SRT22LED- Spectrum Lighting Infinium ™ Pulse Tech LED	14w	27K -2700° K 29K -2900° K 31K -3100° K 41K -4100° K 55K -5500° K	ND (12°) MD (22°) WD (38°)	E1 -Electronic 120v E2 -Electronic 277v Dimming Not Available	MT -Mini Textured Silver MB -Matte Black MW -Matte White CC -Custom Color
SRT22LED	14W	31K	MD	E1	MT

RAZOR EDGE EXTRUSION ORDERING

EXTRUDED SECTION	FINISH
RE2 -2' Razor Edge Extrusion RE4 -4' Razor Edge Extrusion RE6 -6" Razor Edge Extrusion RE8 -8' Razor Edge Extrusion RE90D -90° Corner RE45D -45° Corner RECO -Razor Edge Connector	MT -Mini Textured Silver MB -Matte Black MW -Matte White CC -Custom Color
TEK100	MT

Dimensions shown are nominal. Spectrum Lighting is continually improving products and reserves the right to make changes that will not alter performance or appearance with or without written notice.



PROJECT:	TYPE:
CAT. NO.:	

