

16" SQUARE SERIES SPC16SQ

LENSED 16" SQUARE SPECTRUM CYLINDERS

ED17-175 WATT MAX MH



PRODUCT INFORMATION:

- Shallow 16" square cylinder series for use with metal halide or high pressure sodium lamps.
- Welded heavy gauge aluminum will not rust or corrode.
- 20 color options.
- Special reflector with wide distribution, high spacing and excellent efficiency.
- Suitable for damp location. Wet location available.
- Manufactured and tested to UL standard No. 1598.

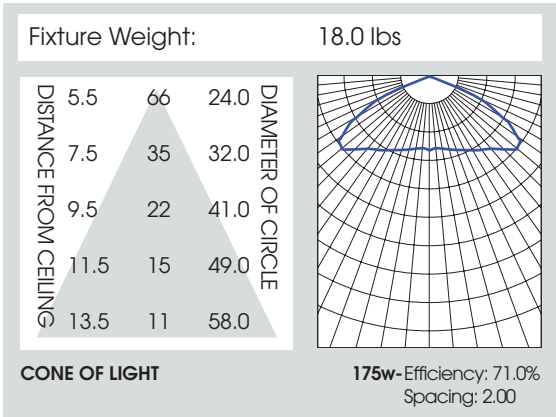
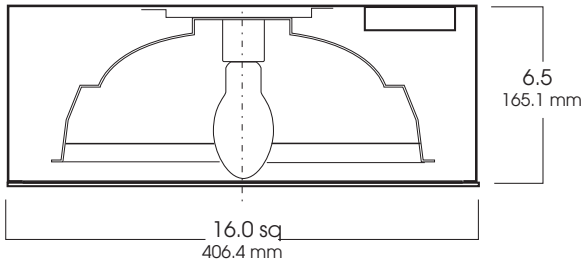

SERIES	WATTS	BALLAST	OPTIONS	TRIM	LENS	MOUNTING	FINISH
SPC1607SQMH- Spectrum Metal Halide Cylinder	50 70 100 150 175	H1 -Magnetic ballast, 120v H2 -Magnetic ballast, 277v	FS -Fuse holder and fuse QRS -Quartz Re-Strike QEM -Quartz Emergency Circuit TP -Tamper Proof	FW -Flush Door	GL -Clear Tempered Glass Lens PG -Prismatic Glass Lens WL -Wet Location	SM -Surface Mount	GW -Gloss White GB -Gloss Black MW -Matte White MB -Matte Black BZ -Bronze PT -Platinum Silver MT -Mini Tek Silver TW -Textured White CC -Custom Color
SPC1607SQMH	100	H1	FS	FW	GL	SM	GW

* For High Pressure Sodium use **HS**

Dimensions shown are nominal. Spectrum Lighting is continually improving products and reserves the right to make changes that will not alter performance or appearance with or without written notice.



PROJECT:	TYPE:
CAT. NO.:	

