

# 12" MRI CYLINDER SERIES LENSED 12" ROUND 100 WATT MAX A19 LAMP



## PRODUCT INFORMATION:

- 12" round shallow MRI cylinder series for use with A19 lamps.
- All aluminum construction.
- 100 watt max A19 lamp. (DC rated).
- 120v standard.
- 20 powder coat options.
- Suitable for damp locations.
- Manufactured and tested to UL standard No. 1598.

## MOUNTING



SM- Surface / Ceiling Mount

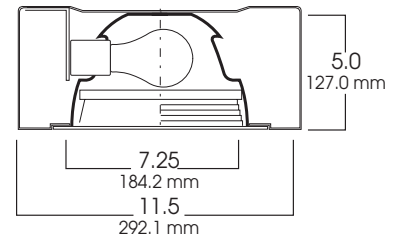

Fixture Weight: 7.0 lbs

SERIES	LAMP	OPTIONS	REFLECTOR	MOUNTING	FINISH
SPC1205MRI- MRI Shallow Spectrum Cylinder	A 19	FS -Fuse holder and fuse GS -Gasket	8320-SG -Soft Glow Alzak- Splay/ Flange (standard) RB -Regressed Baffle / Splay RW -Regressed White Splay	SM -Surface Mount	GW -Gloss White GB -Gloss Black MW -Matte White MB -Matte Black BZ -Bronze PT -Platinum Silver MT -Mini Tek Silver TW -Textured White CC -Custom Color
<b>SPC1205MRI</b>	<b>A19</b>	<b>FS</b>	<b>8320 SG</b>	<b>SM</b>	<b>GW</b>

Dimensions shown are nominal. Spectrum Lighting is continually improving products and reserves the right to make changes that will not alter performance or appearance with or without written notice.



PROJECT:	TYPE:
CAT. NO.:	

