



4" METAL HALIDE SERIES SQUARE APERTURE 39 WATT MAX

D4SQMH
SPECTRUM
GOLD SERIES™

FEATURES & SPECIFICATIONS:

- EFEX2 series MH Square aperture. Fixture features shallow plenum and deep cutoff.
- Intended for Non-IC new construction.
- Frame constructed of 20 ga. aluminum.
- Supplied with 27" long, heavy ga. galvanized steel bar hangers.
- Ballasts shall be integrally mounted, electronic sound rated "A", multi-volt 120v or 277v.
- UL Listed for Damp Locations.
- For options detail, see page numbers listed below.

Max Ceiling Thickness: 1.5 (38.1 mm)
Ceiling Cutout: 5.0² (127.0 mm)²
Fixture Weight: 5.2 lbs

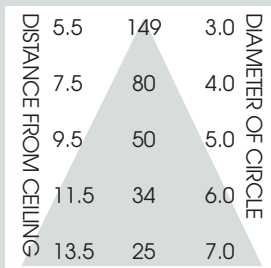

CONE OF LIGHT

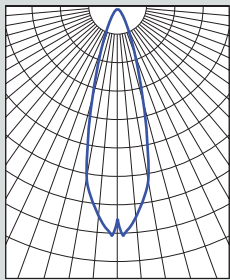

D4SQMH39w-Efficiency: 90.9%
Spacing: 0.54

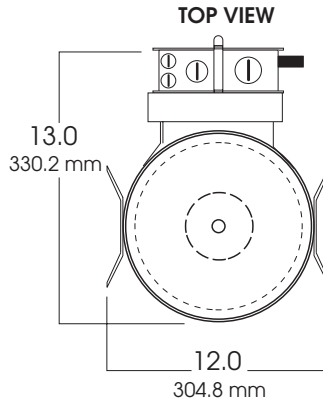
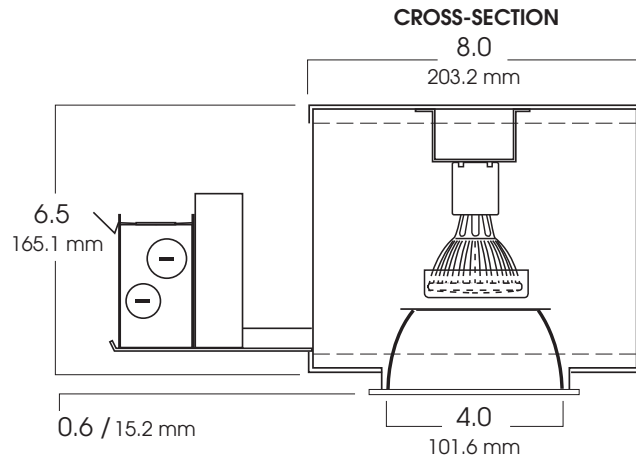

FIXTURE LAMPING

CMH16 - 20W, 39W
PAR20 - 20W, 39W

SERIES	WATTS	BALLAST	LAMP	OPTIONS	TRIM / FINISH	TRIM OPTIONS
SGD4SQMH- Spectrum Gold 4" Vertical Square	20 39	EX -Electronic, multi-volt 120v or 277v	CMH16¹ PAR20²	CB24 -C-Channel bars 1-470 CCEA -Chicago Ceiling Plenum CCEA 1-480 CR -Corrosion Resistant 1-460 FS -Fuse holder and fuse PR -Plaster Ring 1-430 TBC -T-bar clips 1-475 TR -Top Relamping Option	AR0404-SG -Semi-Diffuse Low Iridescent (standard) GM -Corrugated Soft Glow GO -Gold Alzak MB -Matte Black MW -Matte White PW -Pewter Alzak UM -Umber Alzak WE -Wheat Alzak BF -Black Flange WF -White Flange CC -Custom Color	GL -Clear Glass lens PG -Prismatic (T73) lens IX -Micro Prism Industretx™ lens FG -Frosted Glass Lens GS -Gasket WL -Wet Location
SGD4SQMH	20	EX	CMH16	CB24	AR0404 SG	FG

Dimensions shown are nominal. Spectrum Lighting is continually improving products and reserves the right to make changes that will not alter performance or appearance with or without written notice.



PROJECT:	TYPE:
CAT. NO.:	

