

EFEX lighting Solutions





Welcome to Spectrum Lighting's **EFEX** series of recessed down-lights. **EFEX** series fixtures are designed using the latest in lamp and reflector technology. Housings are small, unobtrusive and easy to install. Lamp settings are optimized and all adjustments are lockable. Trims and fittings are made to blend with ceilings and are offered in a variety of finishes and flange types. All Spectrum Lighting products are designed and built in our Fall River, MA factory. We welcome your suggestions and requests.

Please visit our website www.SPECLIGHT.com for compact fluorescent, surface mount, pendant, track, RLM and other lighting solutions from Spectrum Lighting.

Spectrum Lighting... your lighting advantage.



TABLE OF CONTENTS



4" Crystal EFEX	4,5
4" Low Voltage Gallery....	7
4" PAR20 Incandescent.....	8
5" PAR30 Incandescent.....	9
6" Square PAR30/PAR38 Incandescent.....	11
7" PAR30/PAR38 Incandescent.....	12
Insulated Ceiling Fixtures....	14
4" PAR20 Metal Halide.....	17
4" T-4 Mastercolor...	18
5" PAR20/PAR 30 Metal Halide....	20
5" T-4, T-6 Mastercolor...	21
6"&7" T-4, T-6 Mastercolor....	23
6" Square PAR30/PAR38 Metal Halide...	24
7" PAR30/PAR38 Metal Halide....	25
Housing Specifications....	26
Reflector Finishes, Lenses...	27

DECORATIVE CRYSTAL TRIMS

Spectrum Lighting presents **CRYSTAL EFEX**, a dramatic new way to decorate ceiling spaces. **CRYSTAL EFEX** trims are made using Austrian Swarovski Crystal.

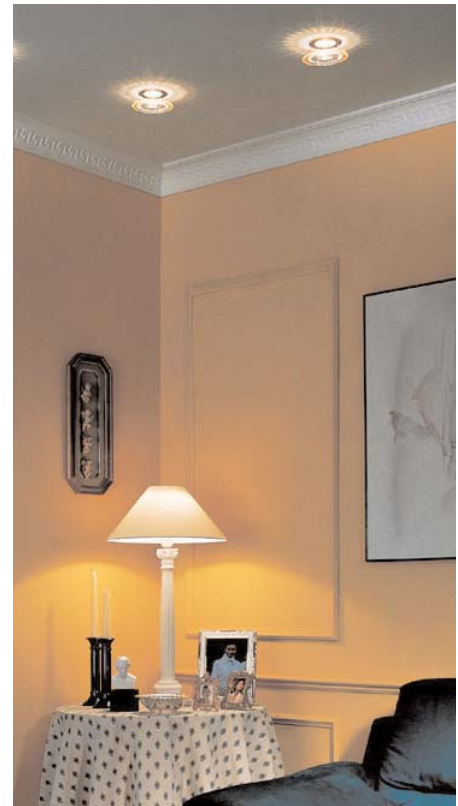
CRYSTAL EFEX trims are designed for use with our DG4X-low voltage, and D4X-Par 20 housings.



CRYSTAL TRIM	MODEL NO.	STANDARD CRYSTALS	OPTIONAL CRYSTALS
	CE1 - Crystal Cluster	Clustered Clear Crystal Ships from stock	CE1Y - Clear and Gold crystals CE1B - Clear and Blue crystals CE1M - Clear and Mauve crystals allow 6-8 weeks for delivery from Austria
	CE2 - Asymmetric Crystal Grouping	Clear and Blue small crystal Ships from stock	CE2Y - Clear and Gold crystals CE2G - Clear and Green crystals CE2R - Clear and Red crystals allow 6-8 weeks for delivery from Austria
	CE3 - Radial Crystal grouping-Frosted Center	Clear/Blue Cut crystals Ships from stock	CE3Y - Clear and Gold crystals CE3C - Clear large Cut crystals allow 6-8 weeks for delivery from Austria

SERIES	LAMP TYPE	WATTS	VOLTAGE	OPTIONS	REFLECTOR /	FINISH	CRYSTAL TRIMS
SGDG4X - 4" LV Downlight SGD4 - 4" PAR20 INC Downlight	MR16 PAR20	35 50	E1 - 120 Electronic Transformer (standard) E2 - 277 Volt Electronic	FS - Fusing ** - Lens- See Page 27 for available lenses BH27 - 27" Mounting Bars TB - T-bar Clips (4) IC - Insulated Ceiling See page 12 for housing size	AR4250 - MR16 Downlight AR4550 - PAR20 Downlight	CL - Clear Alzak SG - Soft Glow * - Colored Alzak *Specify color PF - Polished Flange SEE PAGE 27 FOR COLOR OPTIONS	CE1 - Cluster Crystal Grouping CE2 - Asymmetric Crystal Grouping CE3 - Radial Crystal Grouping-Frosted Center
EXAMPLE:	SGDG4	MR16	50	E	BH27	AR4250CL	CE1

DECORATIVE CRYSTAL TRIMS





LOW VOLTAGE GALLERY

Nothing beats the flexibility of MR-16 lamps for accent lighting.

EFEX has designed a series of fixtures that maximize the MR-16's effectiveness. Adjustable fixtures (AG4X) rotate 361° and angle to a true 45°, maintaining center beam optics.

All adjustments are lockable and can be made with trim in or out.

A variety of spread and diffusion lenses are offered (see page 27).

Direct fixtures (DG4X) have deep reflector cones for excellent cutoff.

All housings are aluminum for heat dissipation, and finished in matte black. Transformers and wiring are accessible through ceiling aperture.

Fixtures are also offered with insulated ceiling (IC), air tight (AT) and wet location (WL) options.



4" APERTURE-LOW VOLTAGE

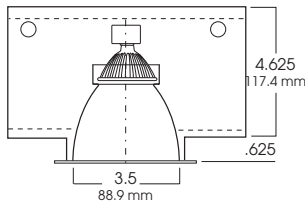

SGDG4X-4" LOW VOLTAGE DOWNLIGHT

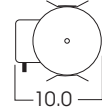
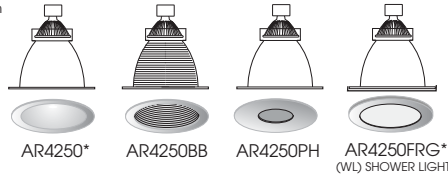

HOUSING:
Ø 8.0 x10.0 OVERALL

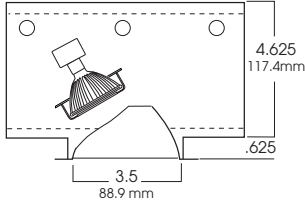

SGAG4X-4" ADJUSTABLE LOW VOLTAGE DOWNLIGHT

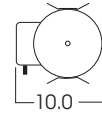
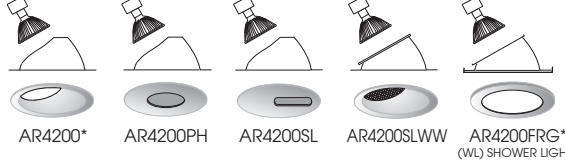

HOUSING:
Ø 8.0 x10.0 OVERALL

ROTATES 361°
ADJUSTS TO 45°

4" SQUARE APERTURE-LOW VOLTAGE

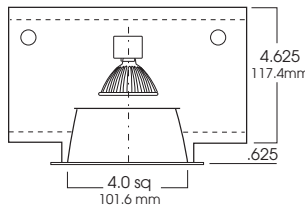

SGDG4SQ- 4" SQUARE LOW VOLTAGE DOWNLIGHT

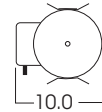
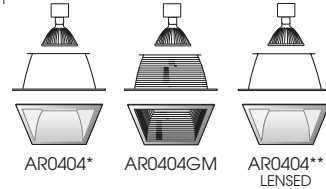

HOUSING:
Ø 8.0 x10.0 OVERALL

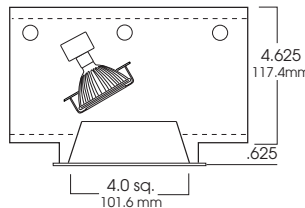

SGAG4SQ- 4" SQUARE ADJUSTABLE LOW VOLTAGE DOWNLIGHT

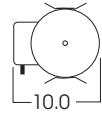
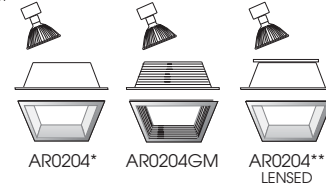

HOUSING:
Ø 8.0 x10.0 OVERALL

ROTATES 361°
ADJUSTS TO 45°

SERIES	LAMP TYPE	WATTS	VOLTAGE	OPTIONS	REFLECTOR / FINISH		
SGDG4X- 4" Low Voltage Downlight	MR16	35	E1T -120 Volt Electronic Transformer (Standard)	FS - Fusing ** - Lens- See Page 27 for available lenses BH27 - 27" Mounting Bars TB - T-bar Clips (4) CP - CCEA SP - Spread Lens IC - Insulated Ceiling Housing FRG - Bezel Mounted Frosted Glass. CRG - Bezel Mounted Clear Glass. WL - Wet Location. (FRG, CLRG only)- See page 27	AR4250- MR16 Downlight AR4200- MR16 Adjustable Downlight AR4200SLWW -MR16 Spread Lens Wall Wash MR16 Sq. Downlight AR0404- MR16 Sq. Downlight AR0204- MR16 Sq. Adjustable Downlight		
SGAG4X- 4" Low Voltage Adjustable		50				OPTIONS	CL - Clear Alzak SG - Soft Glow * - Colored Alzak *Specify color
SGDG4-SQ 4" Sq. Low Voltage Downlight		75				E2T -277 Volt Electronic Transformer MG1 -120 Volt Magnetic Transformer MG2 -277 Volt Magnetic Transformer <i>Magnetic transformer increases fixture length to 12"</i>	PF - Polished Flange BB - Black Micro Baffle WB - White Micro Baffle GM - Grooved Metallic WH - Painted White BK - Painted Black SL - Slot aperture PH - Pin Hole aperture SEE PAGE 27 FOR COLOR OPTIONS
SGAG4-SQ 4" Sq. Low Voltage Adjustable							
EXAMPLE: SGGD4	MR16	50	E1T	BH27	AR4250CL		

4" APERTURE-PAR 20 INCANDESCENT

4" APERTURE-PAR20 INCANDESCENT LAMPS

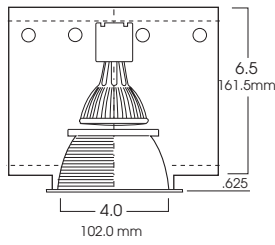

SGD4-4" PAR20 INCANDESCENT DOWNLIGHT

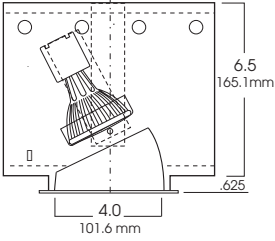
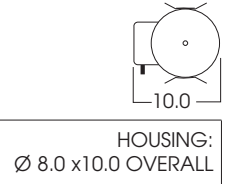
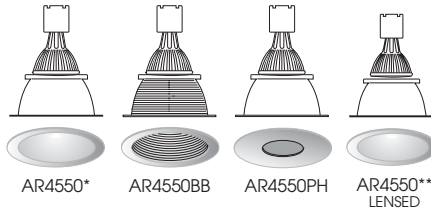

SGA4-4" ADJUSTABLE PAR20 INCANDESCENT

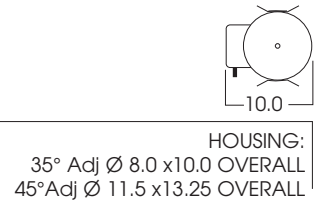
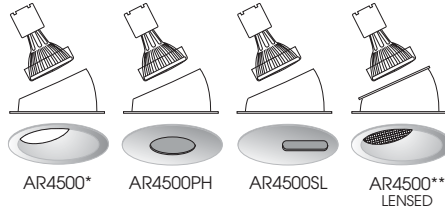

ROTATES 361°
SELECT: 35° OR 45° ADJUSTMENT

4" SQUARE APERTURE-PAR20 INCANDESCENT LAMPS

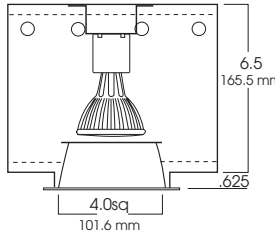

SGD4SQ--4" SQUARE PAR20 INCANDESCENT DOWNLIGHT

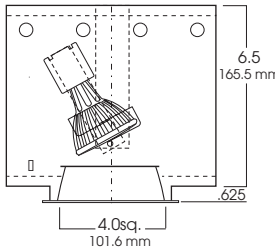
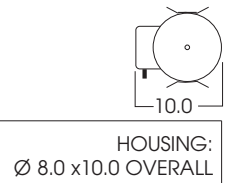
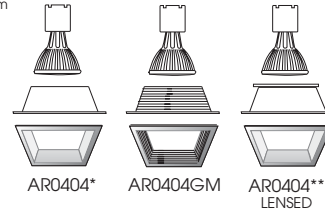

SGA4SQ-4" SQUARE PAR20 INCANDESCENT ADJUSTABLE

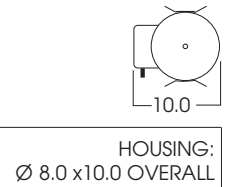
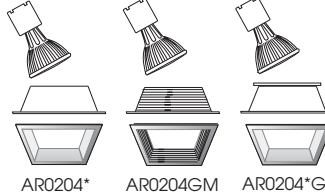

ROTATES 361°
ADJUSTS UP TO 35°

SERIES	LAMP TYPE	WATTS	VOLTAGE	OPTIONS	REFLECTOR / FINISH
SGD4 - 4" Incandescent PAR Downlight	PAR20	35	120-120 (standard)	FS - Fusing ** - Lens- See Page 27 for available lenses	AR4550-PAR Downlight
SGA4 - 4" Incandescent PAR Adjustable 35°		50			T277 -Step-down from 277
SGA445° - 4" Incandescent PAR Adjustable 45°				BH27 - 27" Mounting Bars	CL - Clear Alzak SG - Soft Glow * - Colored Alzak *Specify color
SGD4SQ - 4" Sq.Incandescent PAR Downlight				TB - T-bar Clips (4) CP - CCEA	AR4500SLWW -PAR Spread Lens Wall Wash
SGA4SQ - 4" Sq.Incandescent PAR Adjustable				SP - Spread Lens IC - Insulated Ceiling See page 12 for housing size	AR0404 - Square PAR Downlight AR0204 - Square PAR Adjustable Downlight
					WF - White Flange BB - Black Micro Baffle WB - White Micro Baffle WH - Painted White BK - Painted Black SEE PAGE 27 FOR COLOR OPTIONS

EXAMPLE: **SGD4SQ** **PAR20** **50** **120** **BH27** **AR0404CL**

PAR GALLERY

PAR incandescent lamps offer a wide range of wattages and beam spreads.

EFEX has created a series of fixtures that utilize PAR-20 up to PAR 38 250Watt lamps.

Lamps rotate 361° and can be angled up to 45° in some fixtures. Housings are aluminum for maximum heat dissipation and painted in matte black to eliminate stray glare.

All fixtures have integral plaster rings, and have positive locking torsion springs to secure trim tightly to ceiling.

All wiring is accessible through ceiling aperture. Fixtures are also offered with insulated ceiling (IC), air tight (AT) and wet location (WL) options.



5" APERTURE PAR30 DOWNLIGHT

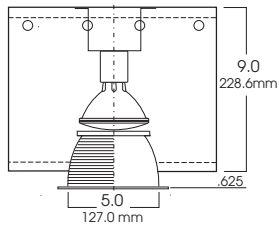

SGD5INC-5" APERTURE PAR30 INCANDESCENT DOWNLIGHT

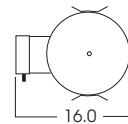
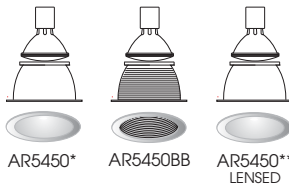

HOUSING:
Ø 11.5 X16.0 OVERALL

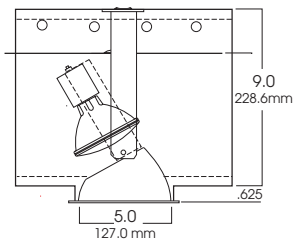

SGA5INC-5" APERTURE ADJUSTABLE PAR30 INCANDESCENT

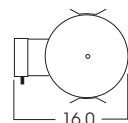
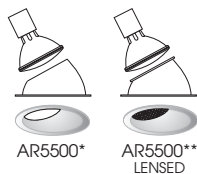

HOUSING:
Ø 11.5 X16.0 OVERALL

ROTATES 361°
ADJUSTS TO 37°

SERIES

SGD5IN-
5" Incandescent
PAR30 Downlight
SGA5IN-
5" Incandescent
PAR30 Adjustable

LAMP TYPE
PAR 30

WATTS
50
60
75

VOLTAGE
120-120
(standard)
T277-Step-down
from 277

OPTIONS

FS- Fusing
******- Lens- See Page 27 for
available lenses
PG- Prismatic Glass Lens
BH27- 27" Mounting Bars
TB- T-bar Clips (4)
CP- CCEA
SP- Spread Lens
IC- Insulated Ceiling
See page 12 for
housing size

CONE/ FINISH

AR5450- PAR30
Downlight
AR5500- PAR30
Adjustable
AR5500SLWW- PAR
Spread Lens
Wall Wash
CL - Clear Alzak
SG - Soft Glow
***** - Colored Alzak
*Specify color
WF - White Flange
BB - Black Micro Baffle
WB - White Micro Baffle
WH - Painted White
BK - Painted Black
**SEE PAGE 27 FOR
COLOR OPTIONS**

EXAMPLE: SGD5IN

PAR30

50

120

BH27

AR5450CL



COUNTRY MUSIC HALL OF FAME

6" SQUARE APERTURE - PAR INCANDESCENT

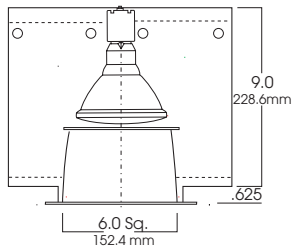

6" SQUARE APERTURE INCANDESCENT DOWNLIGHT

SGD6SQIN- 6" SQUARE PAR30/PAR38 INCANDESCENT DOWNLIGHT

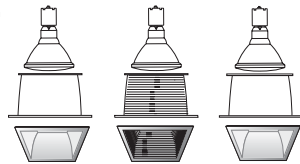

AR0606* AR0606GM AR0606**
LENSD

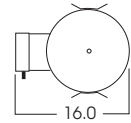

HOUSING:
Ø 11.5 x16 OVERALL

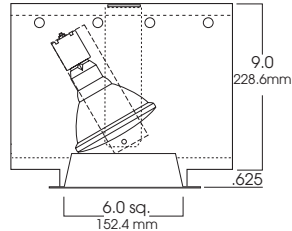

SGA6SQIN- 6" SQUARE PAR30/PAR38 INCANDESCENT ADJUSTABLE

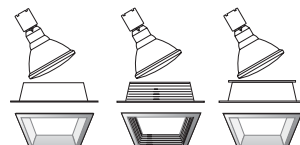

AR0306* AR0306GM AR0306**
LENSD

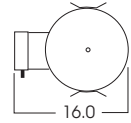

HOUSING:
Ø 11.5 X16.0 OVERALL

ROTATES 361°
ADJUSTS TO 35°

SERIES

SGD6SQIN-
6" Sq. Incandescent
Downlight
SGA6SQIN-
6" Sq.
Incandescent
Adjustable

LAMP TYPE

PAR30
PAR38

WATTS

50
60
75
100
150
250

VOLTAGE

120-120
(standard)
T277-Step-down
from 277

OPTIONS

FS- Fusing
******- Lens- See Page 27
for available lenses
PG- Prismatic Glass
Lens
BH27- 27" Mounting
Bars
TB- T-bar Clips (4)
CP- CCEA
SP- Spread Lens
IC- Insulated Ceiling
See page 12 for
housing size

CONE/ FINISH

AR0606- PAR30
Downlight
AR0306- PAR30
Adjustable

CL- Clear Alzak
SG- Soft Glow
***** - Colored Alzak
*Specify color
WF- White Flange
BB- Black Micro Baffle
WB- White Micro Baffle
GM- Grooved Metallic
WH- Painted White
BK- Painted Black
**SEE PAGE 27 FOR
COLOR OPTIONS**

EXAMPLE: **SGD6SQIN**

PAR30

150

120

BH27

AR0606CL

7" APERTURE-INCANDESCENT PAR

7" APERTURE DOWNLIGHT PAR INCANDESCENT

SGD7IN-7" PAR30/38 INCANDESCENT DOWNLIGHT

HOUSING: Ø11.5 x 16.0 OVERALL

SGA7IN-7" PAR 30/38 INCANDESCENT ADJUSTABLE

ROTATES 361°
ADJUSTS TO 35°

HOUSING: Ø11.5 x 16.0 OVERALL

7" APERTURE SPREAD LENSED WALL WASH INCANDESCENT

SGL7IN-7" PAR30/38 INCANDESCENT SPREAD LENSED WALL WASH

ROTATES 361°

HOUSING: Ø11.5 X 16.0 OVERALL

SERIES	LAMP TYPE	WATTS	VOLTAGE	OPTIONS	CONE/ FINISH
SGD7IN- 7" Incandescent PAR Downlight	PAR30 PAR38	50 60 75 100 150 250	120-120 (standard) T277 -Step-down from 277	FS- Fusing ** - Lens- See Page 27 for available lenses PG- Prismatic Glass Lens BH27- 27" Mounting Bars TB- T-bar Clips (4) CP- CCEA IC- Insulated Ceiling See page 12 for housing size	AR7400- Downlight AR7500- Adjustable Downlight AR7900- Lensed Wall Wash Downlight CL - Clear Alzak SG - Soft Glow * - Colored Alzak *Specify color WF - White Flange WH - Painted White BK - Painted Black SEE PAGE 27 FOR COLOR OPTIONS
SGA7IN- 7" Incandescent PAR Adjustable					
SGL7IN- 7" Lensed Incandescent PAR Wall Wash					
EXAMPLE: SGD7IN	PAR38	150	120	BH27	AR7400CL



INSULATED CEILING FIXTURE HOUSINGS

EFEX INSULATED CEILING HOUSINGS

Below is a chart listing sizes for EFEX IC option housings. All IC housings are constructed of .04 thick aluminum and designed for direct contact with insulation.

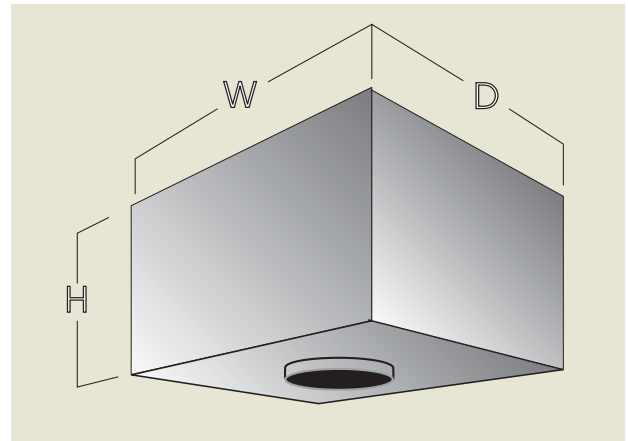

		MAX WATTAGE	H	W	D	
4" APERTURE	SGDG4XIC 4" Low Voltage MR16 Downlight	50W	9.5	13.0	10.5	
	SGAG4XIC 4" Low Voltage MR16 Adjustable	50W	9.5	13.0	10.5	
4" SQUARE APERTURE	SGDG4SQIC 4" Sq. Low Voltage MR16 Downlight	50W	9.5	13.0	10.5	
	SGAG4SQIC 4" Sq. Low Voltage MR16 Adjustable	50W	9.5	13.0	10.5	
4" APERTURE	SGD4IC 4" Incandescent PAR Downlight	50W	9.5	13.0	10.5	
	SGA4IC 4" Incandescent PAR Adjustable	50W	9.5	13.0	10.5	
4" SQUARE APERTURE	SGD4SQIC 4" Sq. Incandescent PAR Downlight	50W	9.5	13.0	10.5	
	SGA4SQIC 4" Sq. Incandescent PAR Adjustable	50W	9.5	13.0	10.5	
5" APERTURE	SGD5INIC 5" Incandescent PAR Downlight	50W	9.5	13.0	10.5	
	SGA5INIC 5" Incandescent PAR Adjustable	50W	9.5	13.0	10.5	
6" SQUARE APERTURE	SGD6SQINIC 6" Sq. Incandescent PAR Downlight	100W	11.5	13.0	10.5	
	SGA6SQINIC 6" Sq. Incandescent PAR Adjustable	100W	11.5	13.0	10.5	
7" APERTURE	SGD7INIC 7" Incandescent PAR Downlight	100W	11.5	13.0	10.5	
	SGA7INIC 7" Incandescent PAR Adjustable	100W	11.5	13.0	10.5	
	SGL7INIC 7" Incandescent PAR SLWW	100W	11.5	13.0	10.5	



